

FCU1

User Manual V2.0 2024.06

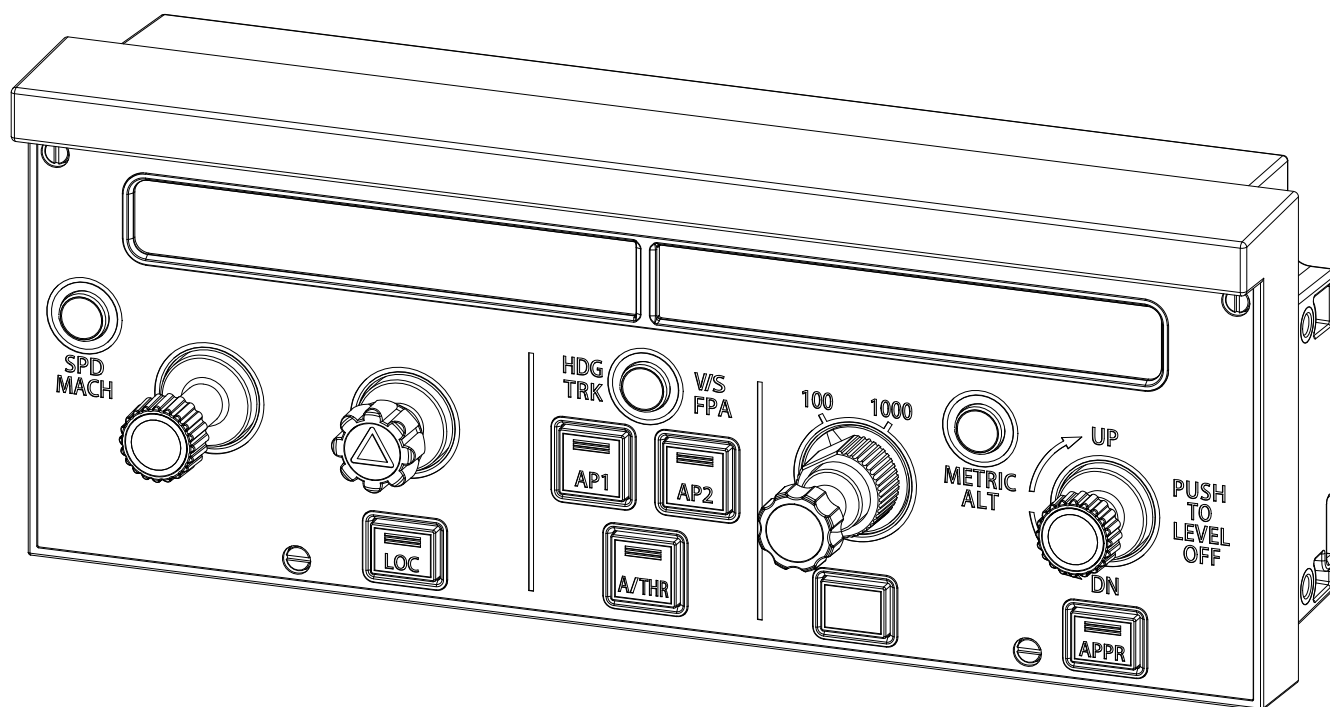

Catalog:

1 Parameters	2
1.1 Performance Parameters	2
1.2 Applicable Models	3
1.3 Dimensions	4
1.4 Installation Dimensions	5
2 Function	7
2.1 Mechanical/Special Functions	7
2.2 Buttons	7
2.3 Adjustment Methods	8
3 Assembly and Disassembly of Components	8
4 Installation Methods	8
4.1 Bracket Installation	8
4.2 Gaming Seat Mounting	23
4.3 Cockpit Mounting*	23
4.4 Cascading	24

Cockpit panel and installation screws need to be provided by the user.

Package List

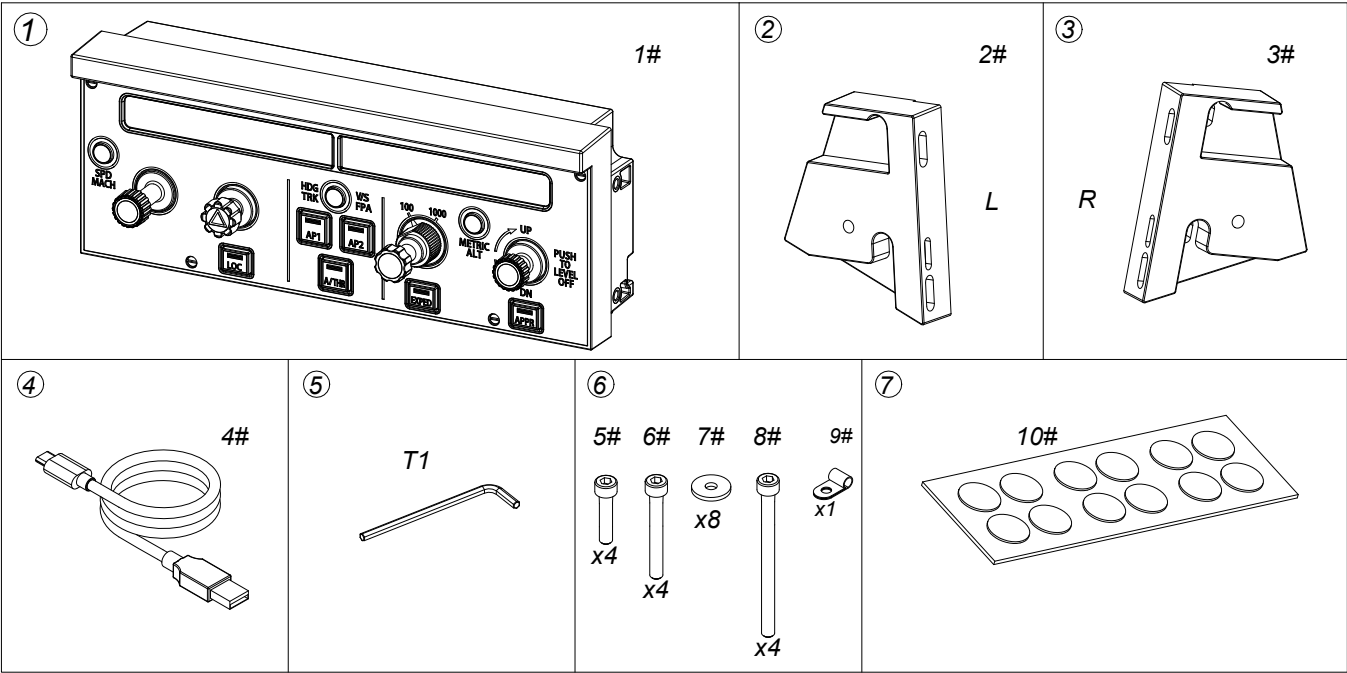

①	FCU1 (1#)	1
②	Mounting Bracket-left (2#)	1
③	Mounting Bracket-right (3#)	1
④	Data Cable (4#)	1
⑤	Tools Kit (T1)	1
⑥	Accessories Kit 1 (5#-9#)	1

5#	Hexagon Socket Screw M5*16	6#	Hexagon Socket Screw M5*22
7#	Washer M5*10*1	8#	Hexagon Socket Screw M5*40
9#	R-shaped Clamp UC-0.5		

⑦	Nanometer Double Sided Adhesive Dots (10#)	1
---	--	---

1Parameters

1.1Performance Parameters

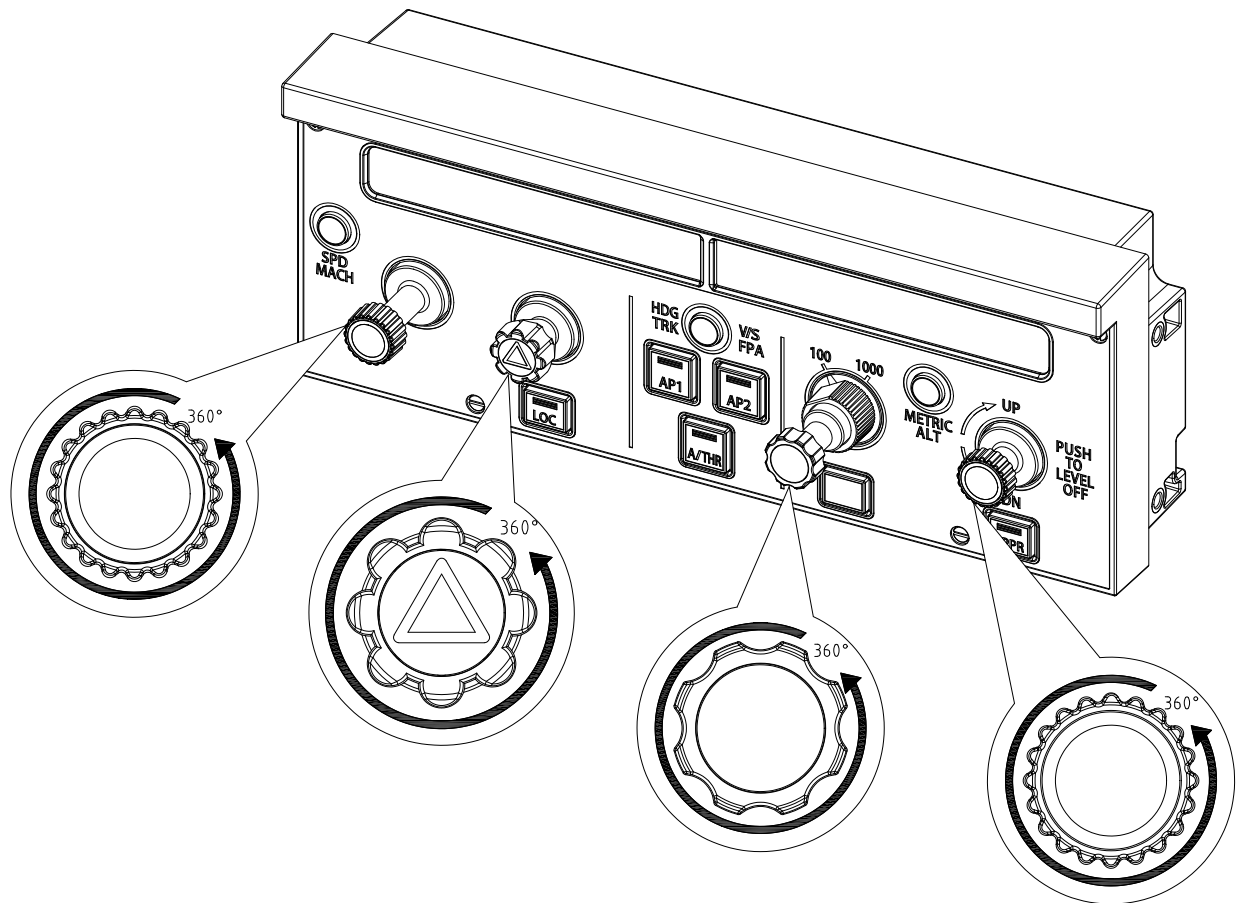
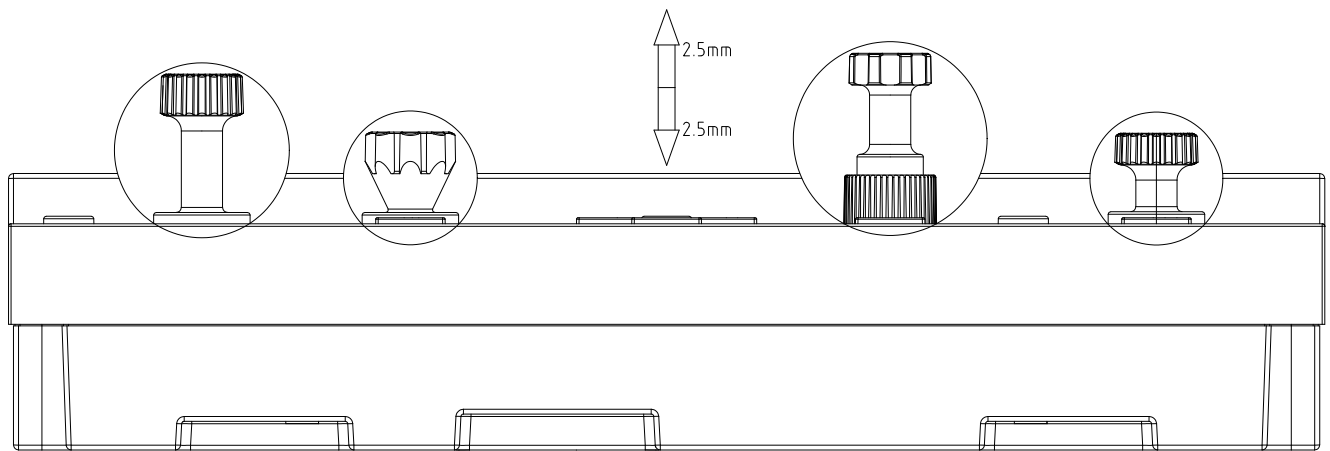

① 4 knobs, with push and pull stroke of 2.5mm each, and a rotational angle of 360° (without detents).

*Note: Only push, pull, and rotate, do not bend; bending damage force 500gf; maximum rotational torque 150gf·cm, maximum push-pull force 1200gf.

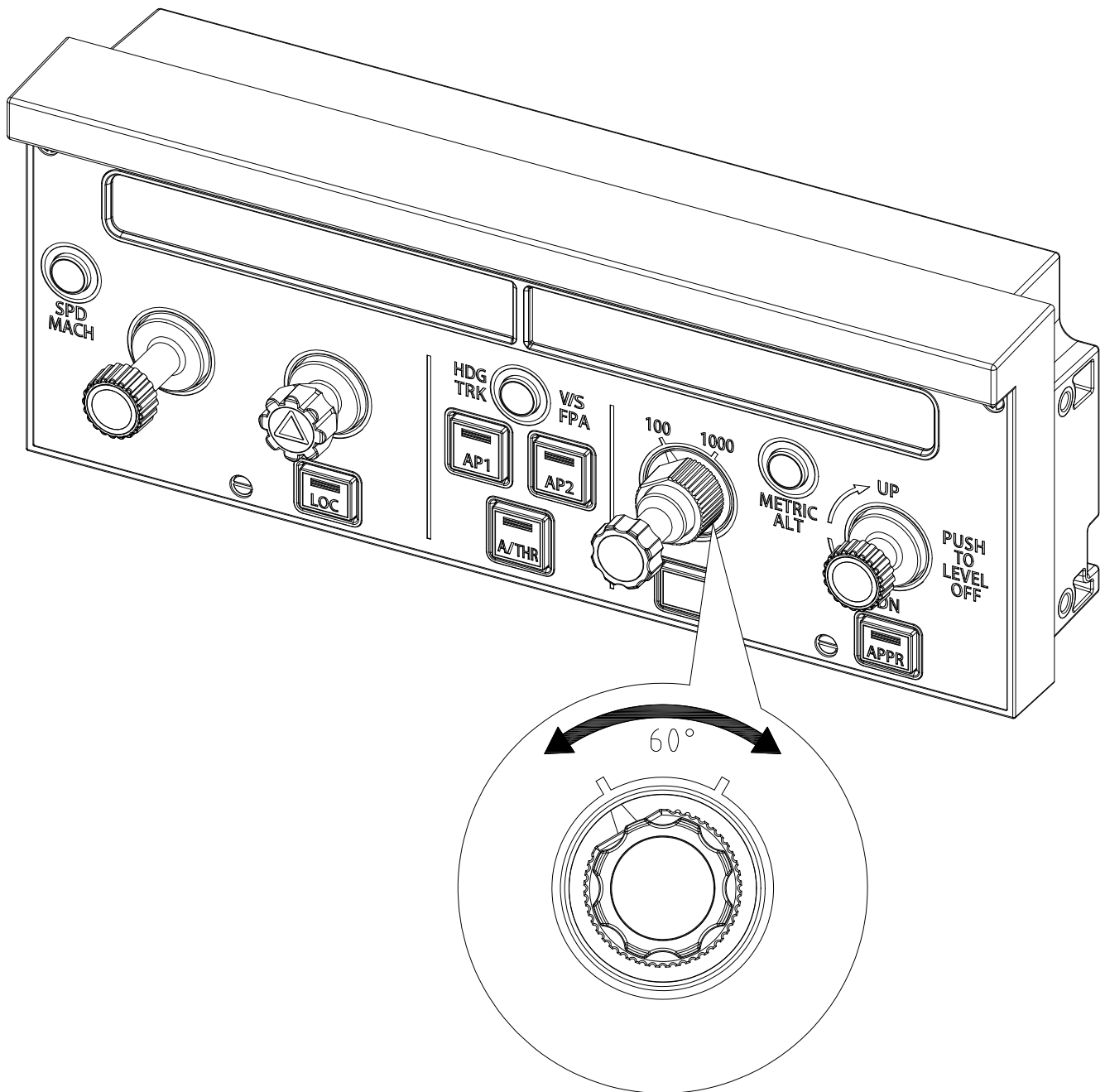

- ② This gear's rotational angle is 60° .

*Note: Only rotate, do not pull or extract; pulling or extracting damage force 300gf.

1.2 Applicable Models

- ① Can be used independently.
- ② Can be cascaded with various control panels through the bracket (Stay tuned for the later products).
- ③ Supports installation on 4080 aluminum profiles (profiles and related accessories need to be provided by yourself).

1.3 Dimensions

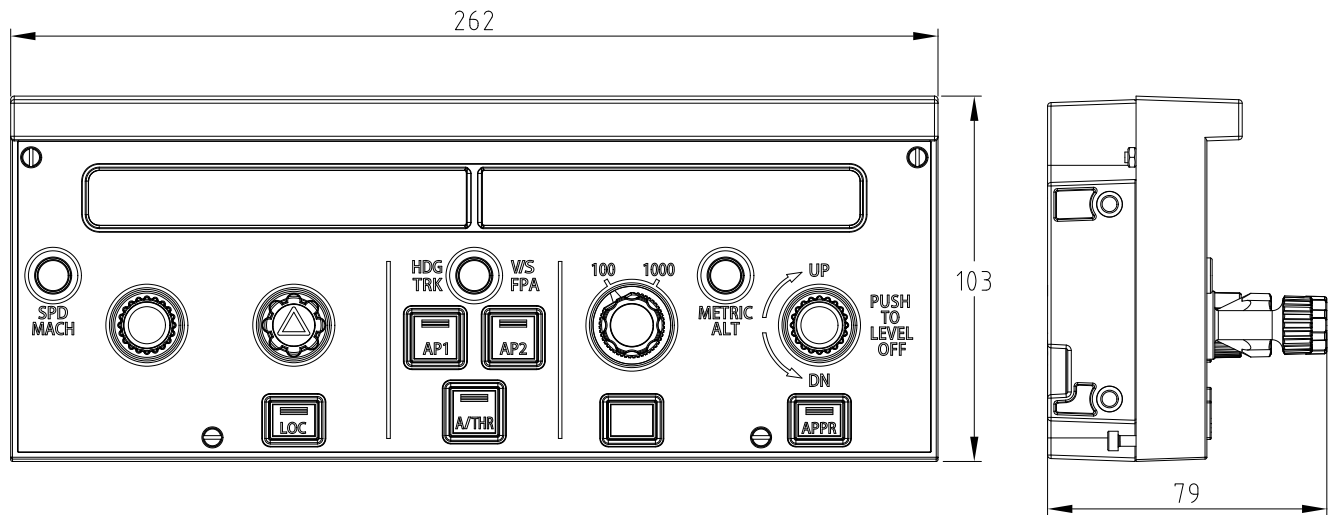

*The product length,width and height is 262mm*103mm*79mm respectively;The weight is 0.5kg=1.1lb.

1.4 Installation Dimensions

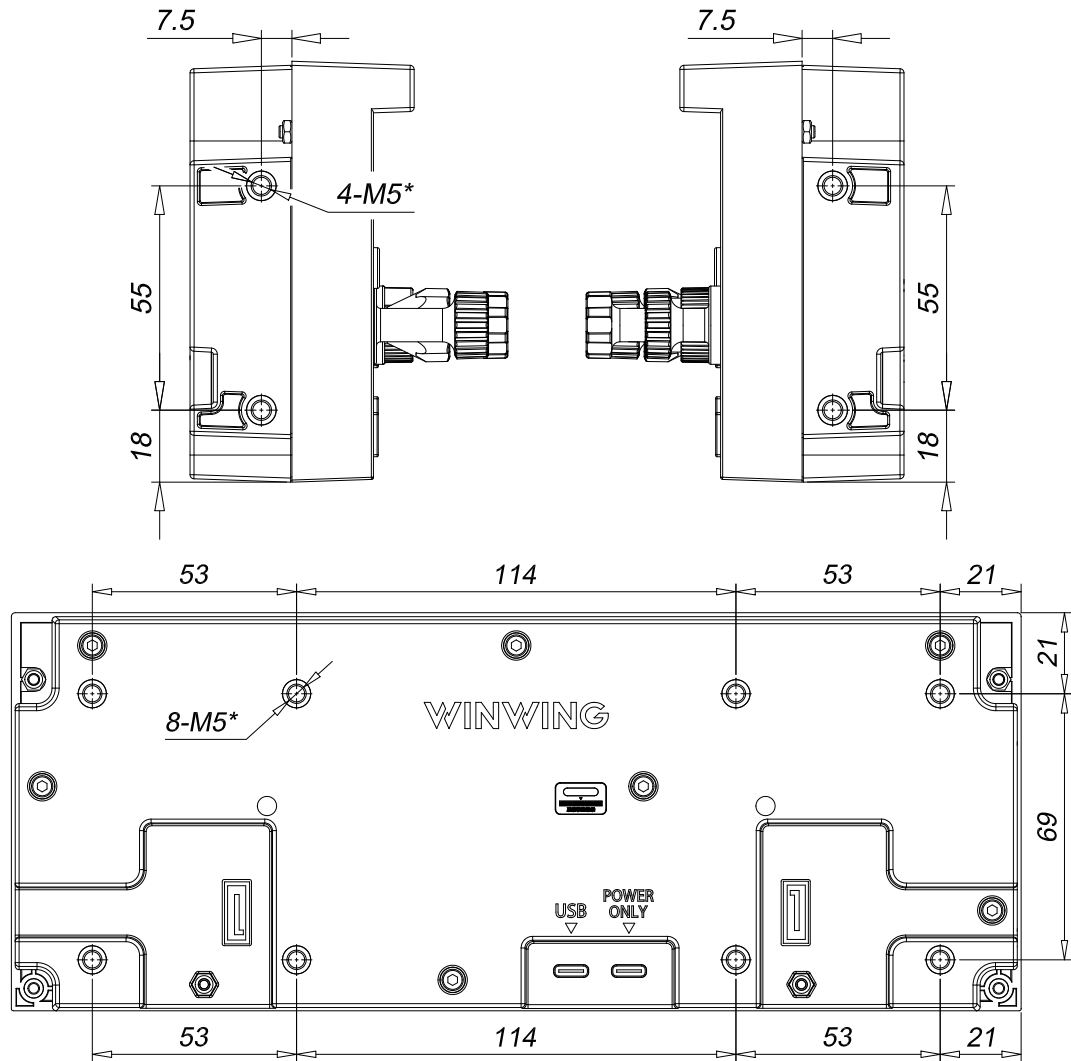

*4-M5, 8-M5 maximum depth 5mm.

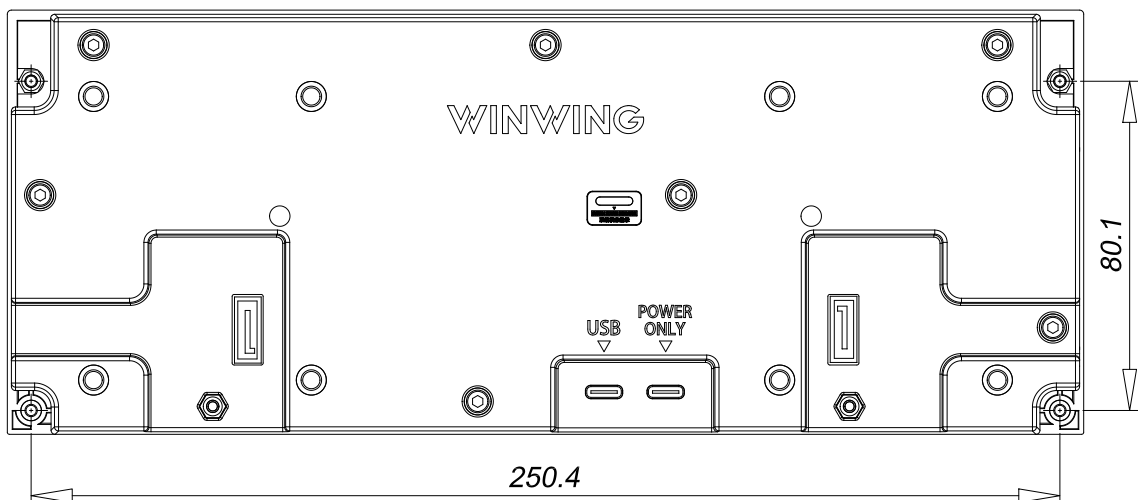

*Diagram showing cockpit panel installation dimensions.

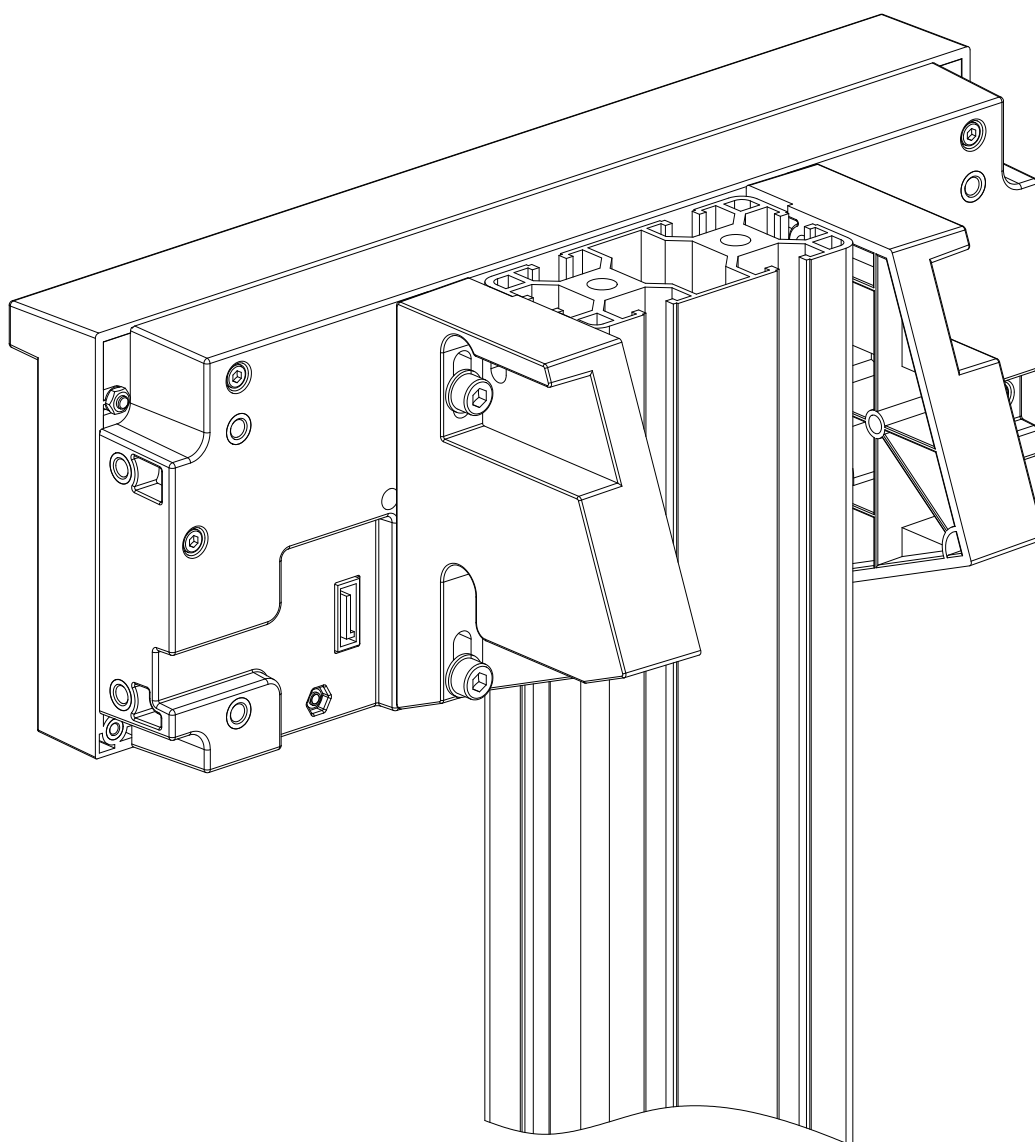
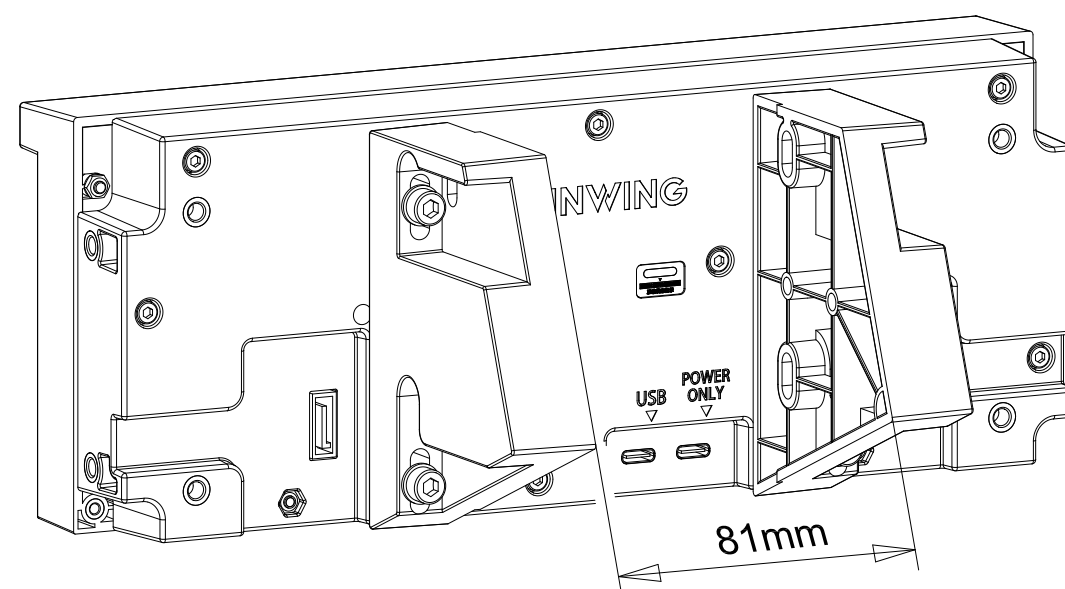

*Diagram for installation on 4080 aluminum profiles (profiles and accessories need to be provided by yourself, installation instructions on page 13, specifications of accessories to be provided on page 15).

2 Function

2.1 Mechanical/Special Functions

\

2.2 Buttons

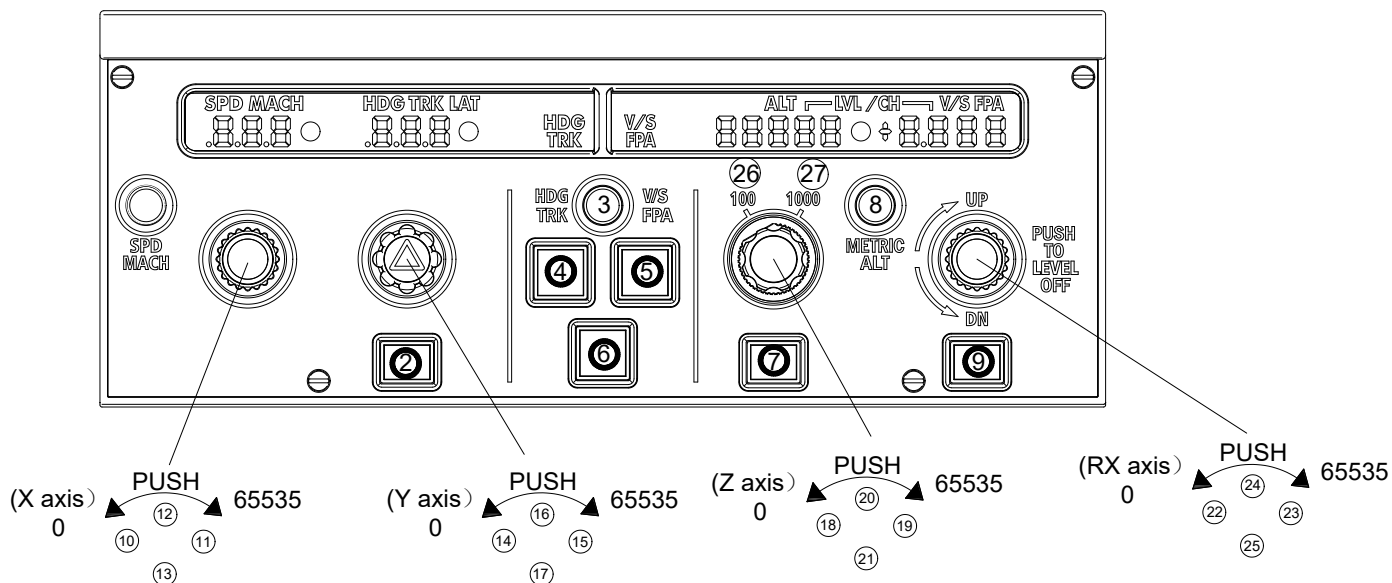

*The Z axis cannot rotate simultaneously with the 26th and 27th buttons; when operating the 26th and 27th buttons, the Z axis rotation signal will be automatically blocked.

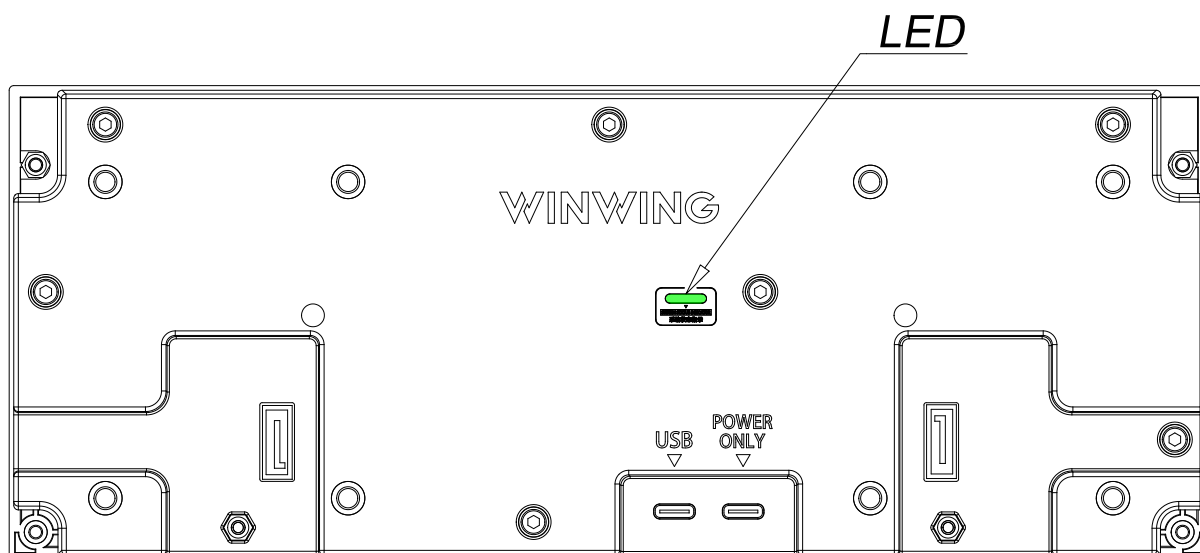

*LED Status Display:

Steady slow flashing in green (1s interval) – BOOT mode.

Slow flashing in green (1s interval) for 5 times, then steady ON – Operational mode.

Slow flashing in green (1s interval) for 5 times, then OFF – Power supply only mode..

2.3 Adjustment Methods

\

3 Assembly and Disassembly of Components

\

4 Installation Methods

4.1 Bracket Installation

1. Desktop Installation Method 1 (Recommended)

① Bracket Installation Method: Install at a 71-degree angle with the desktop (actual Aircraft perspective is 71 degrees).

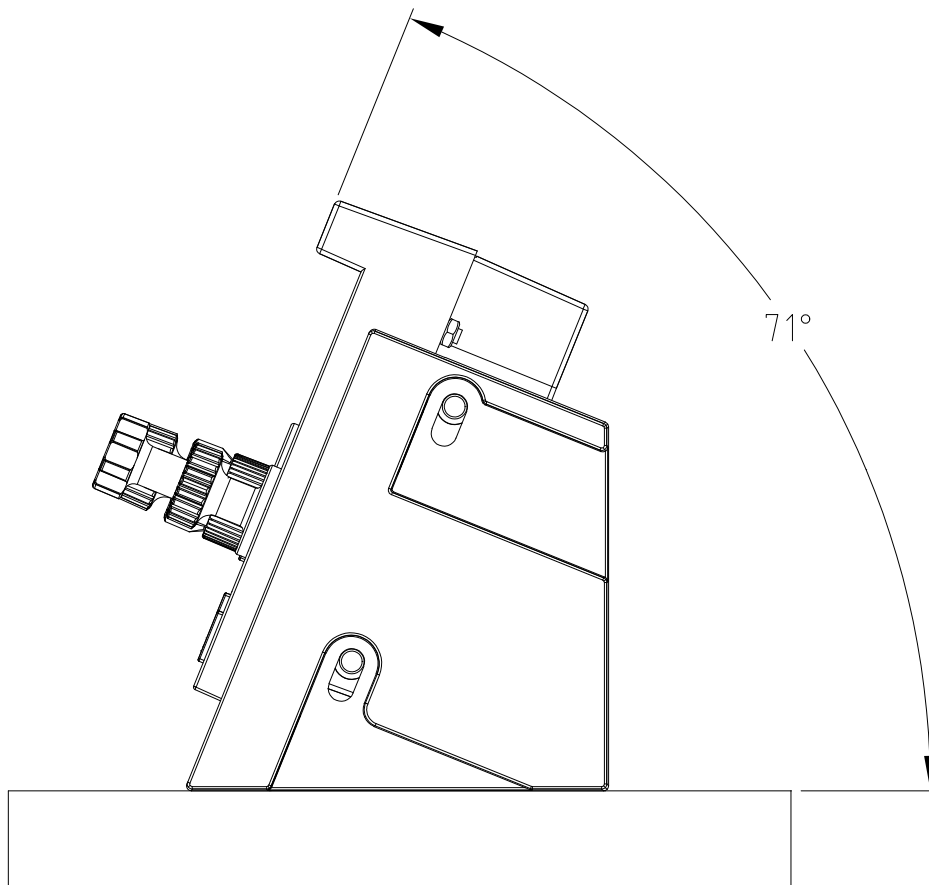

② Left and right bracket installation methods.

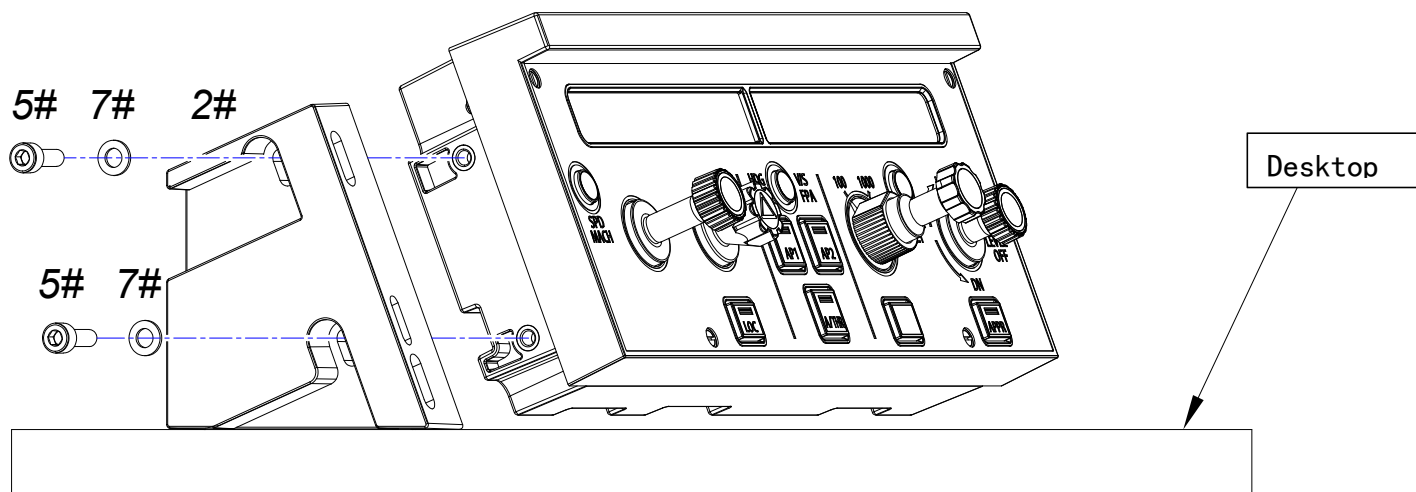

*Turn the screw in place, but do not tighten it yet.

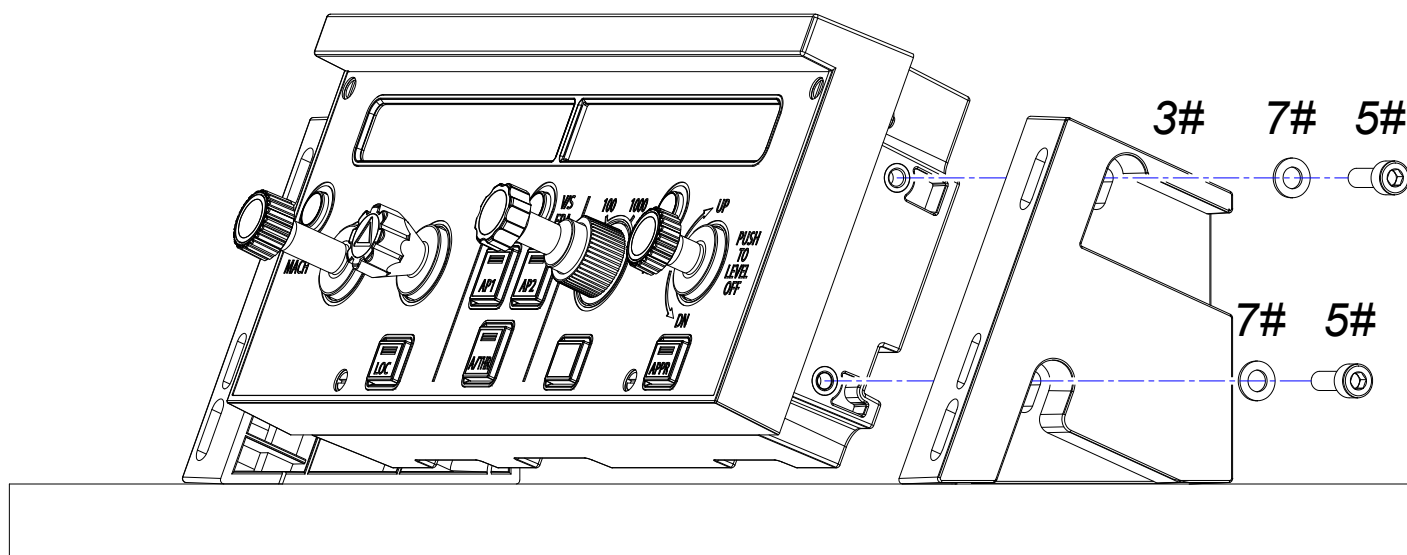

*Turn the screw in place, but do not tighten it yet.

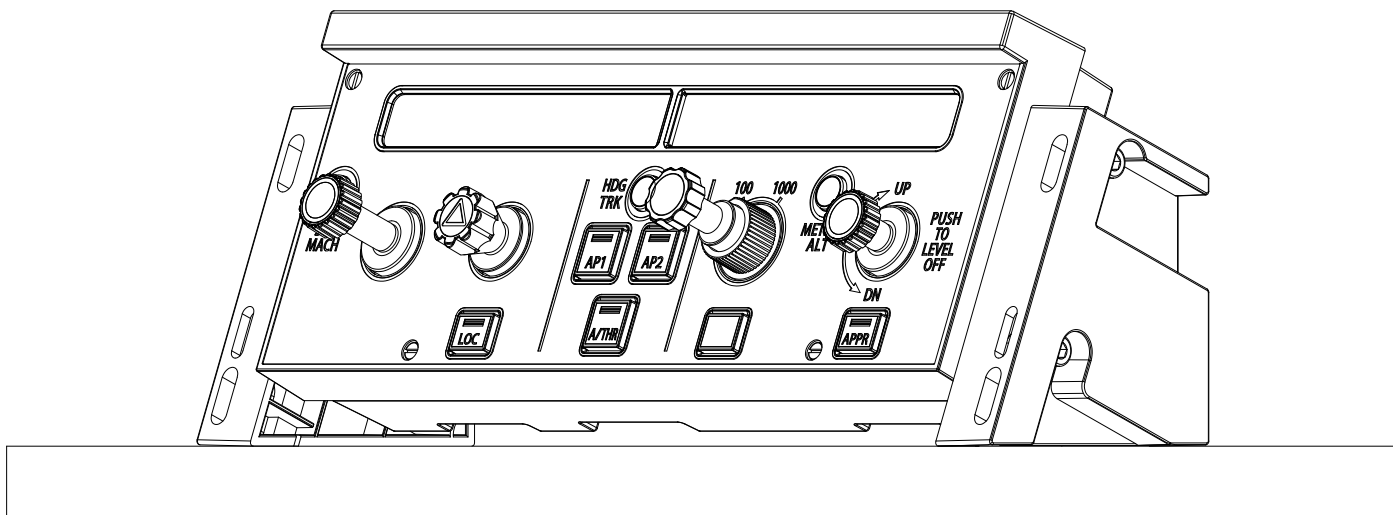

*Adjust the bracket position up and down until it sits steadily on the desktop before tightening the screws.

*Tighten the screws until there is no wobbling; over-tightening may cause damage.

③ Apply Nanometer Double Sided Adhesive Dots. (8#)

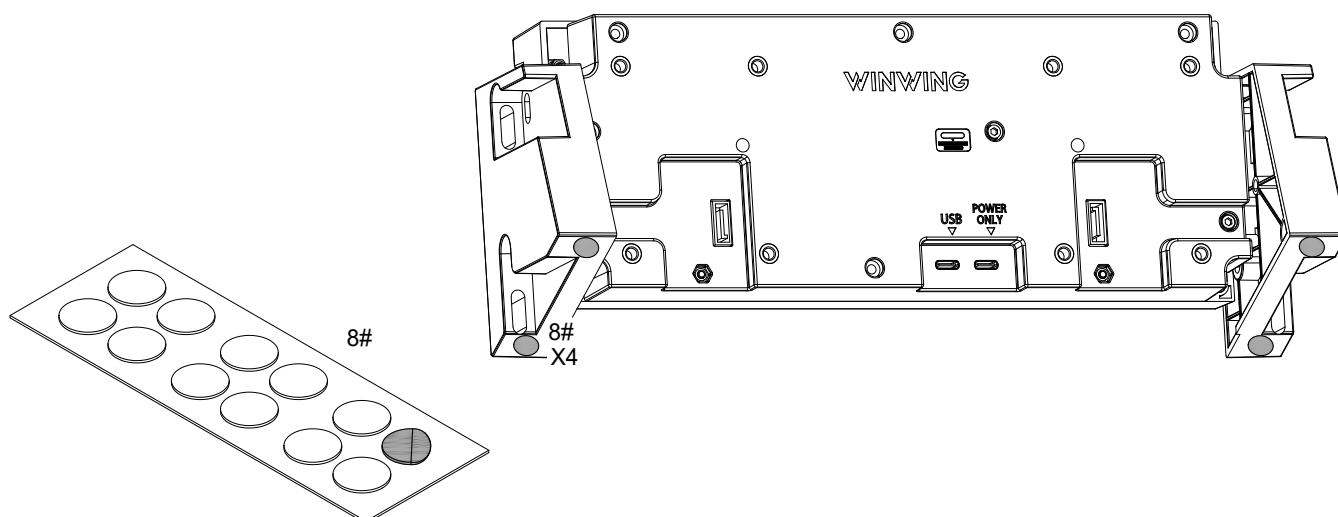

*Clean the dust off the bracket surface before installation.

2. Desktop Installation Method 2

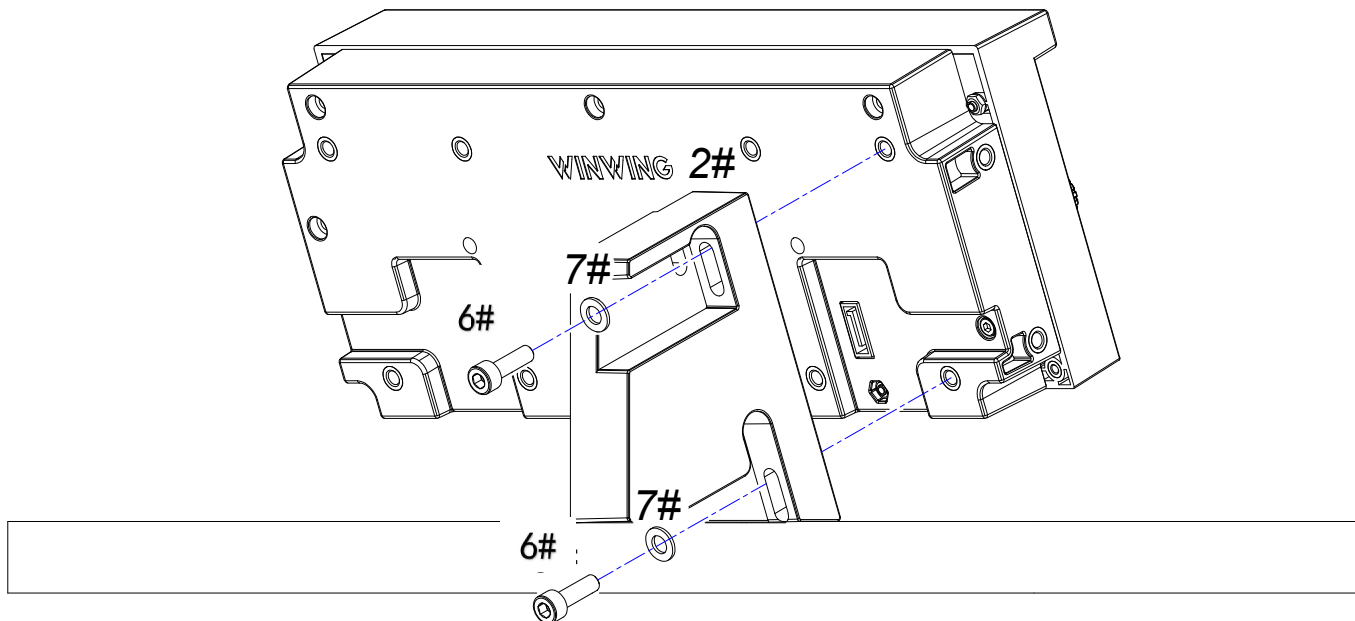

*Turn the screw in place, but do not tighten it yet.

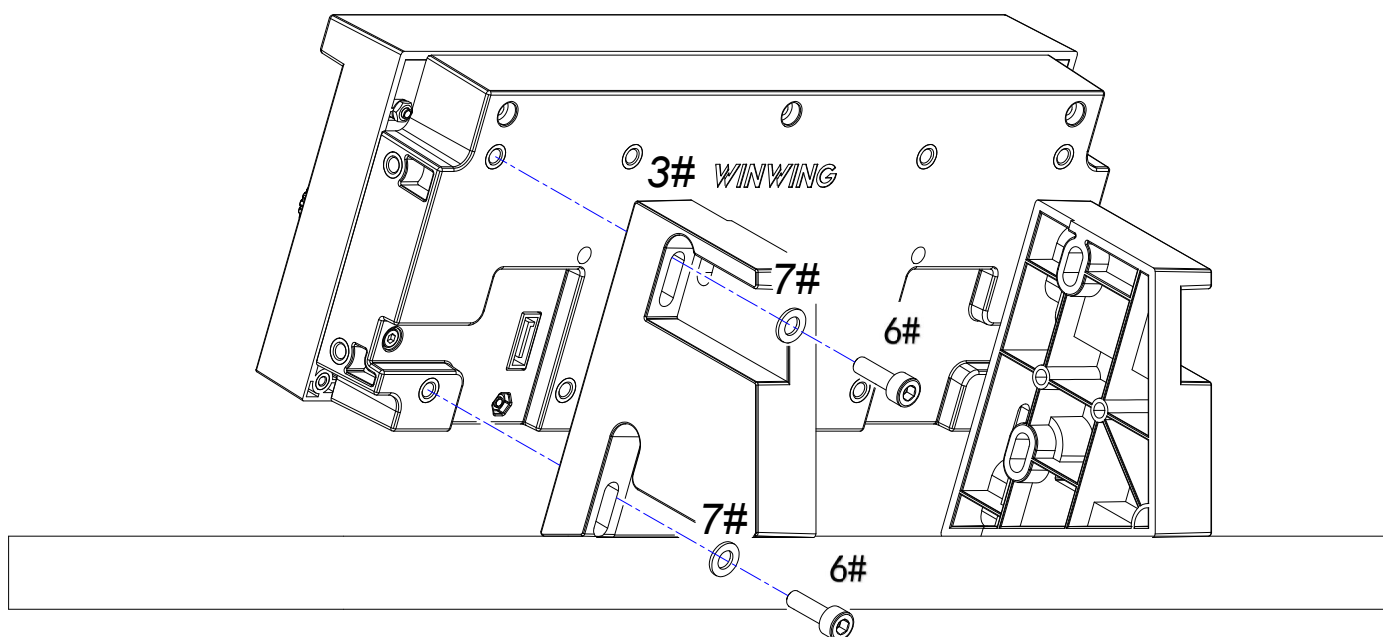

*Turn the screw in place, but do not tighten it yet.

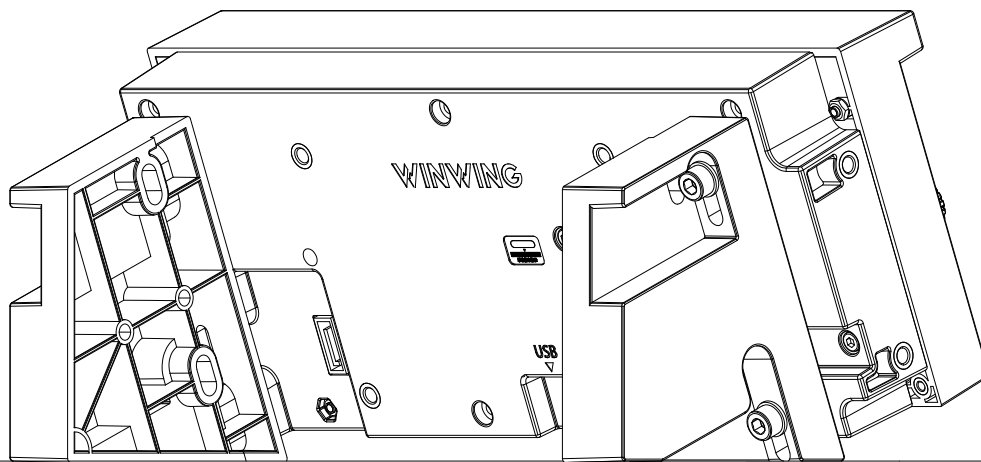

*Adjust the bracket position up and down until it sits steadily on the desktop before tightening the screws.

*Tighten the screws until there is no wobbling; over-tightening may cause damage.

*Paste the Nanometer Double Sided Adhesive Dots to the bottom of the bracket

*Installation method for other mounting holes is the same as above.

3. Profiles Installation Method (*profiles and related accessories need to be prepared by yourself)

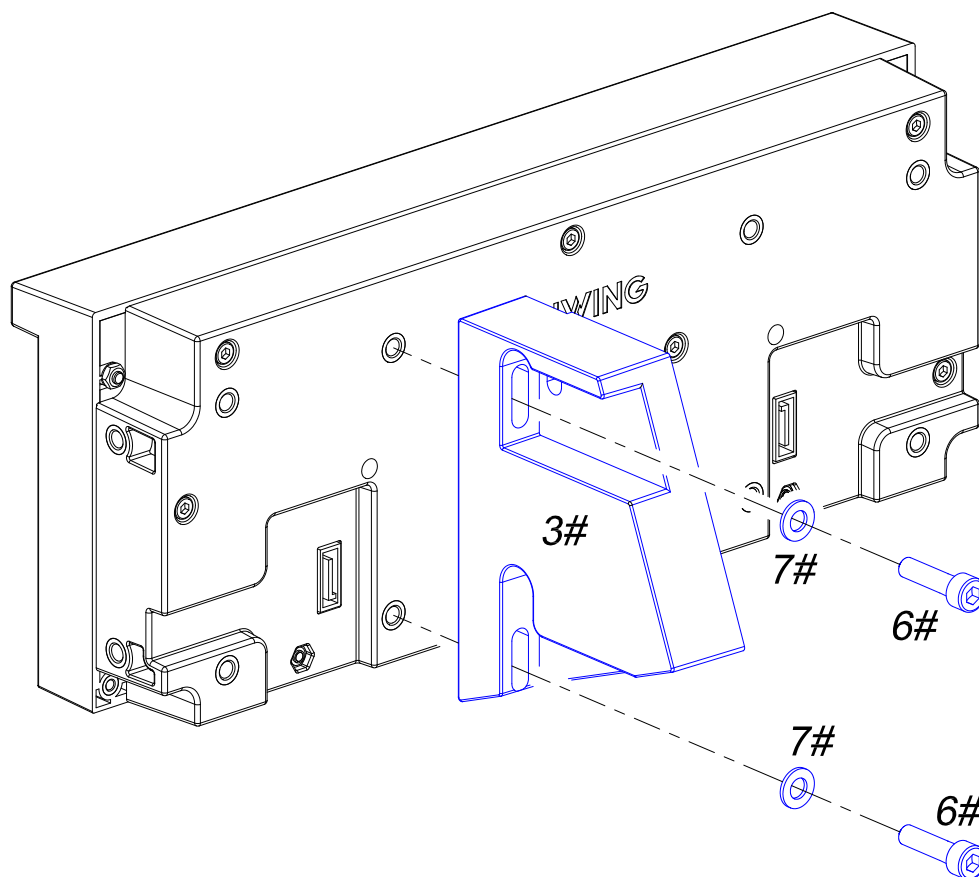

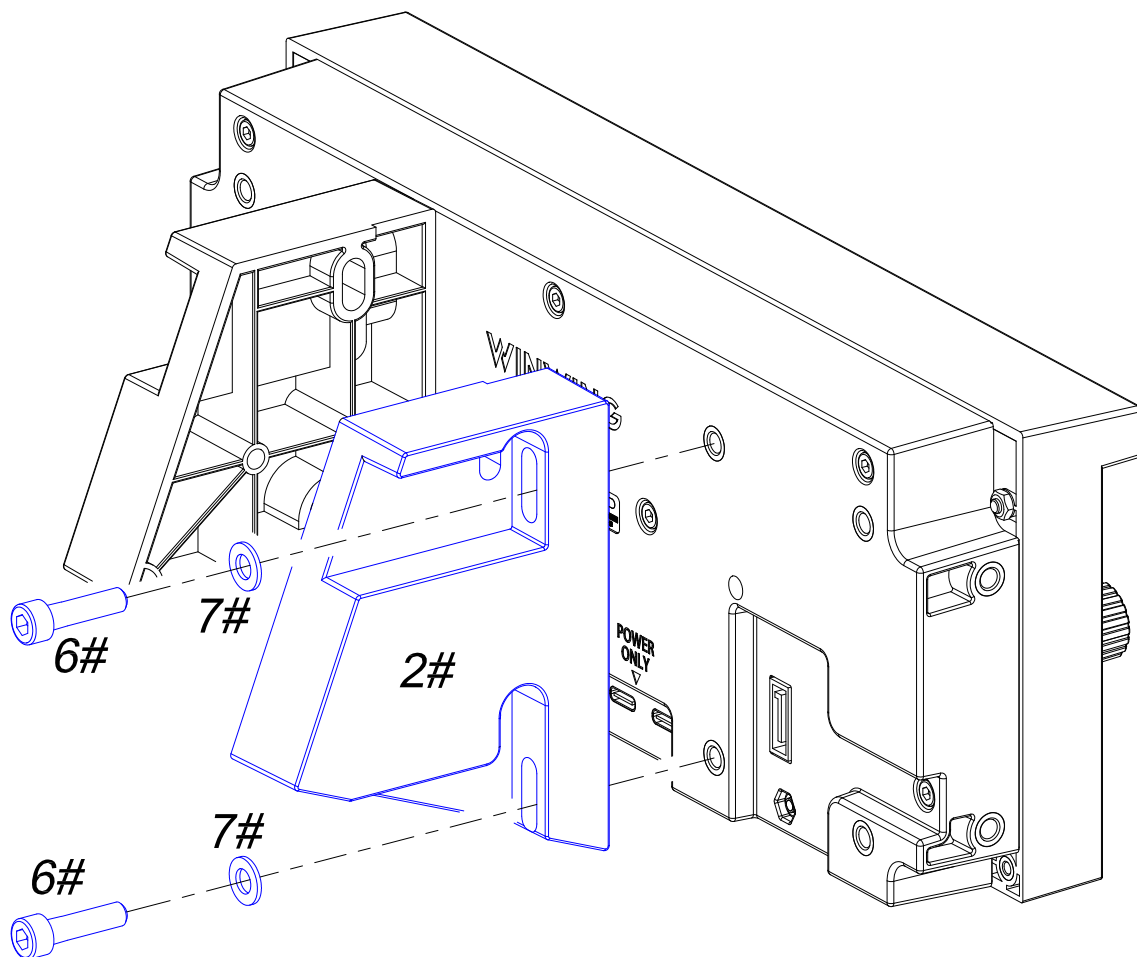

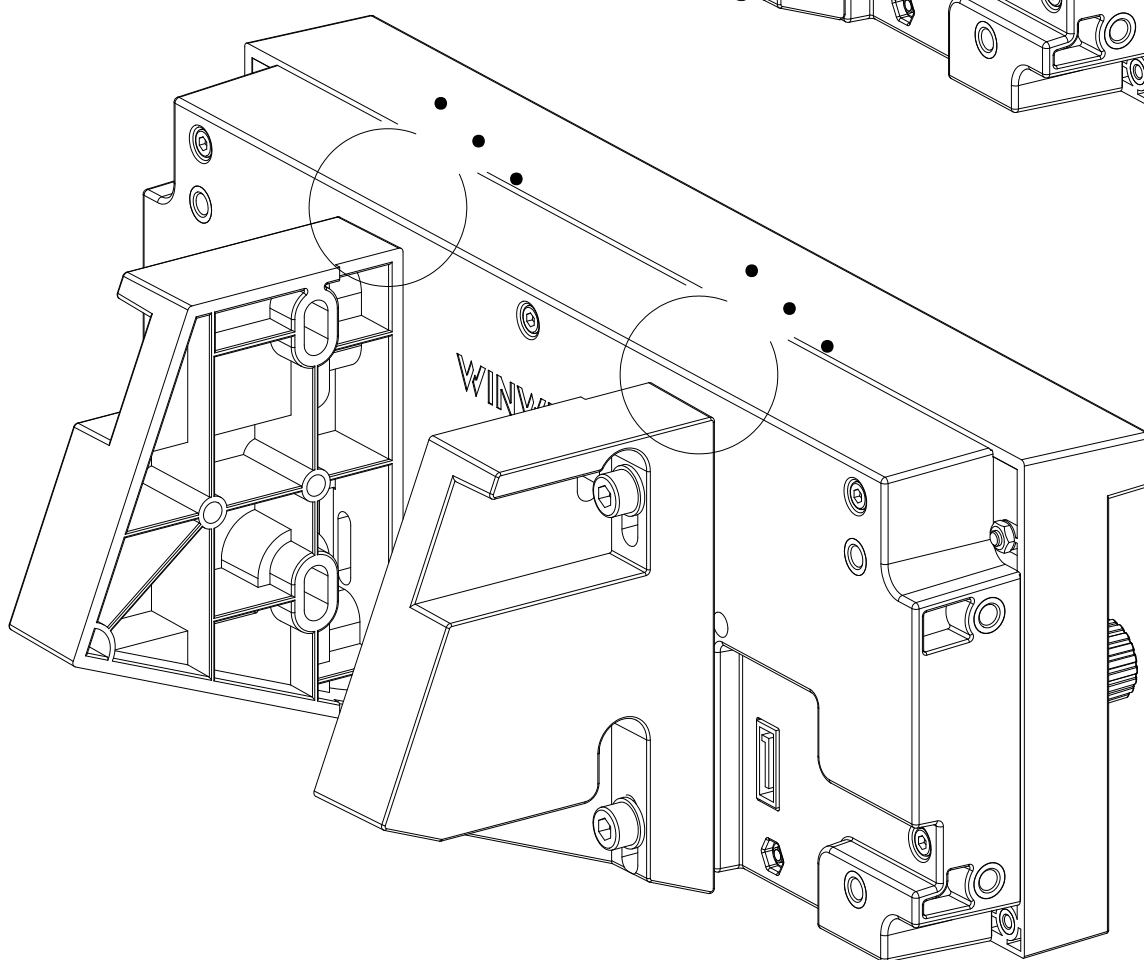
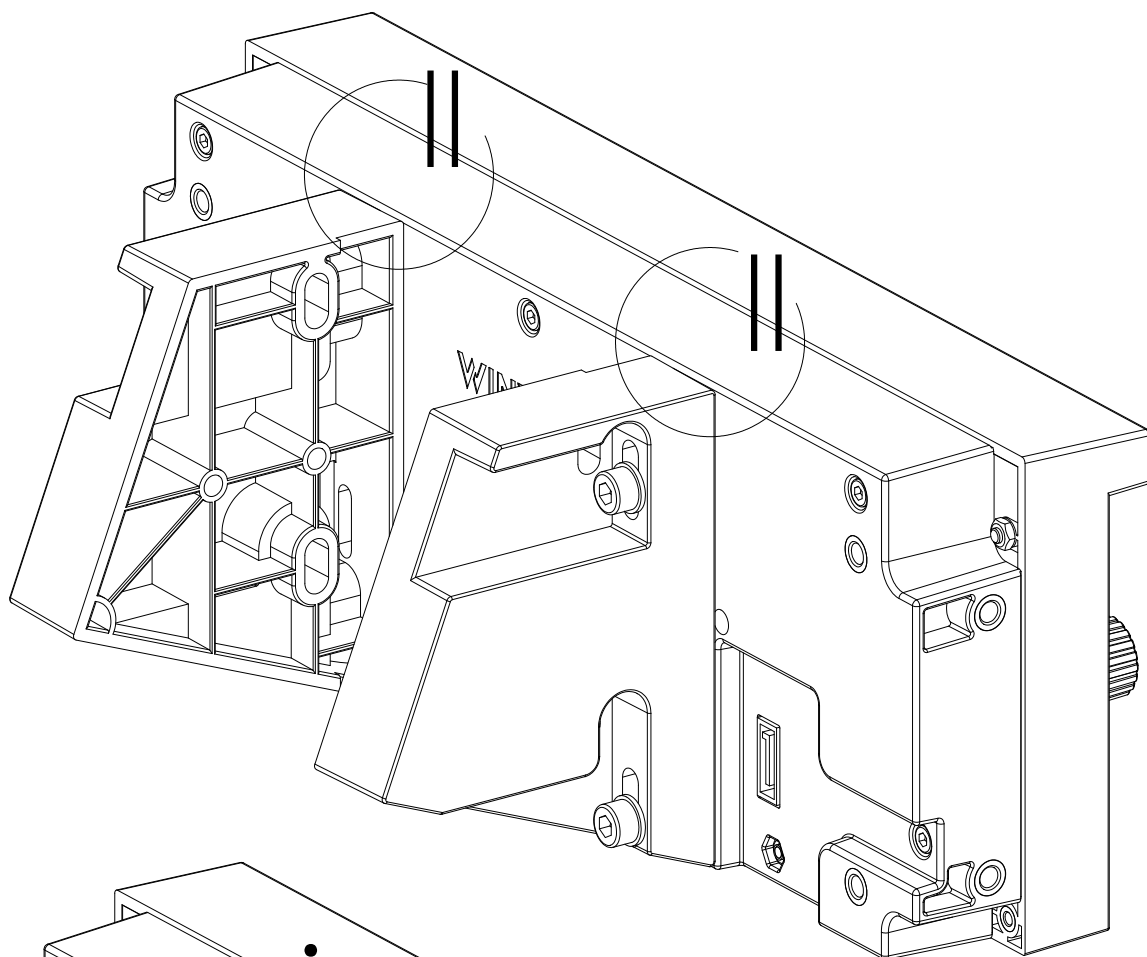

Specifications of Accessories (Recommended)

Item	Specifications	Quantity (at least)
Profile	EU Standard 4080	1
Profile Nut	40 type - M5	4
Hexagon socket round screw	M5*20	4
Flat Washer	φ5	4
Data Cable	TYPE-C USB	1

*The height dimension of the TYPE-C data cable head should be $\leq 8\text{mm}$ (as shown on the right)

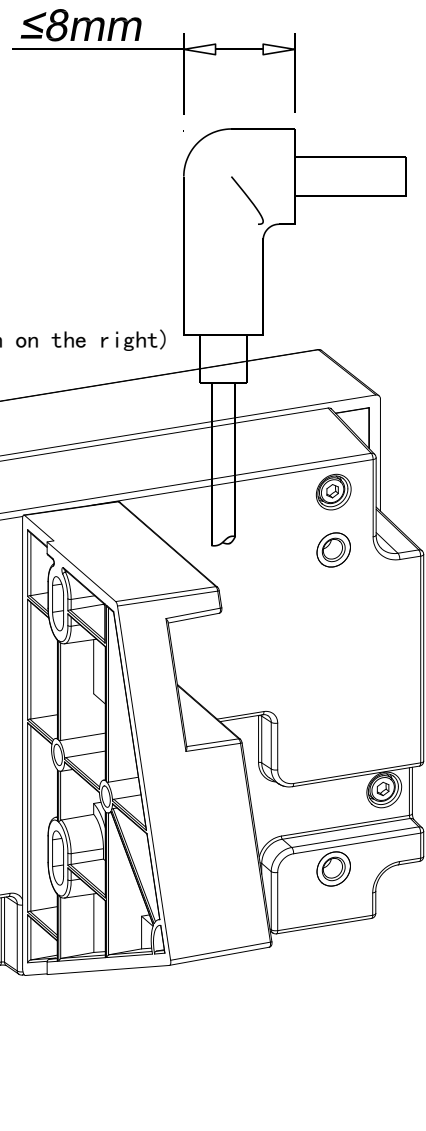

Insert the data cable

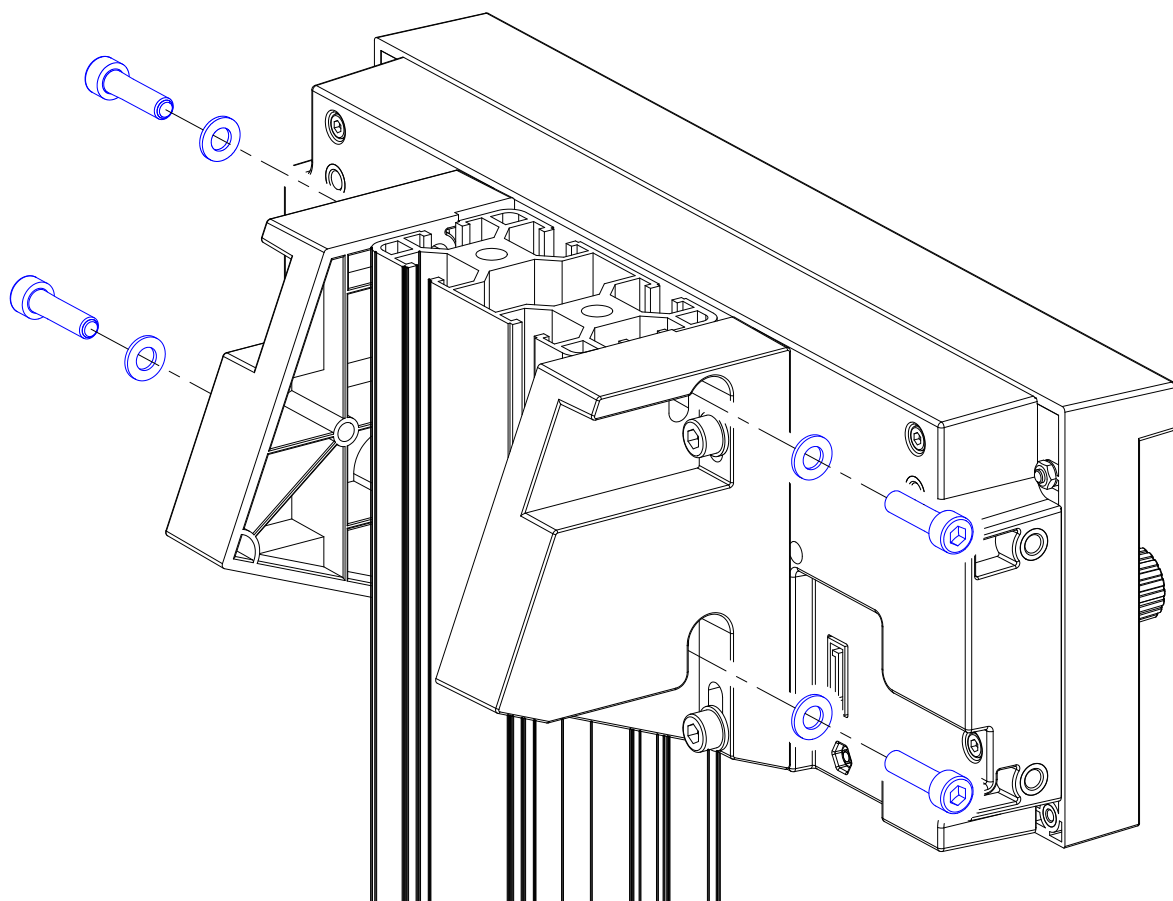
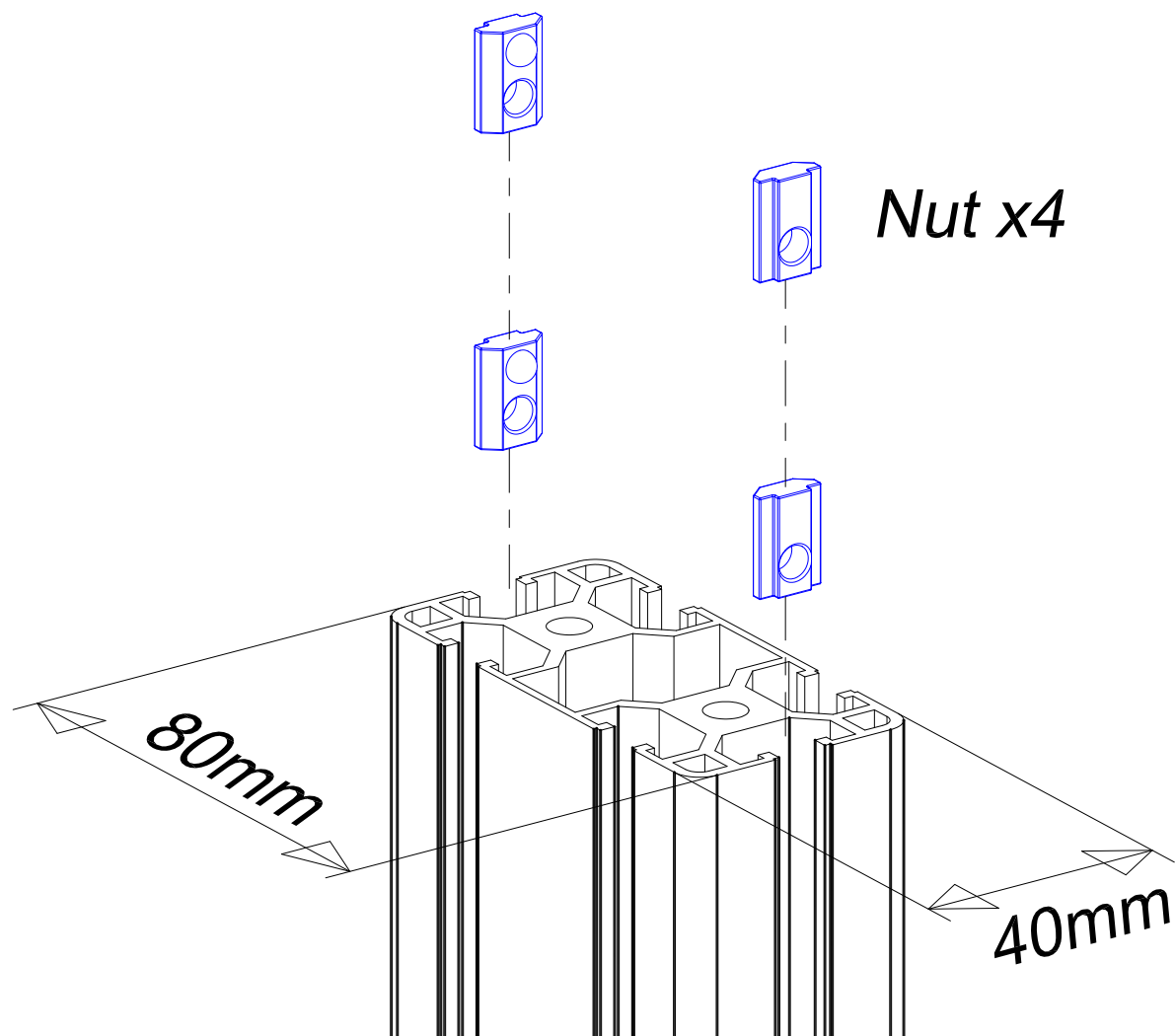

4. Panel Mount (MP1) Installation (*MP1 needs to be purchased additionally)

Packing List of MP1

Note: MP1 needs to be purchased additionally, please see MP1 User Manual for details.

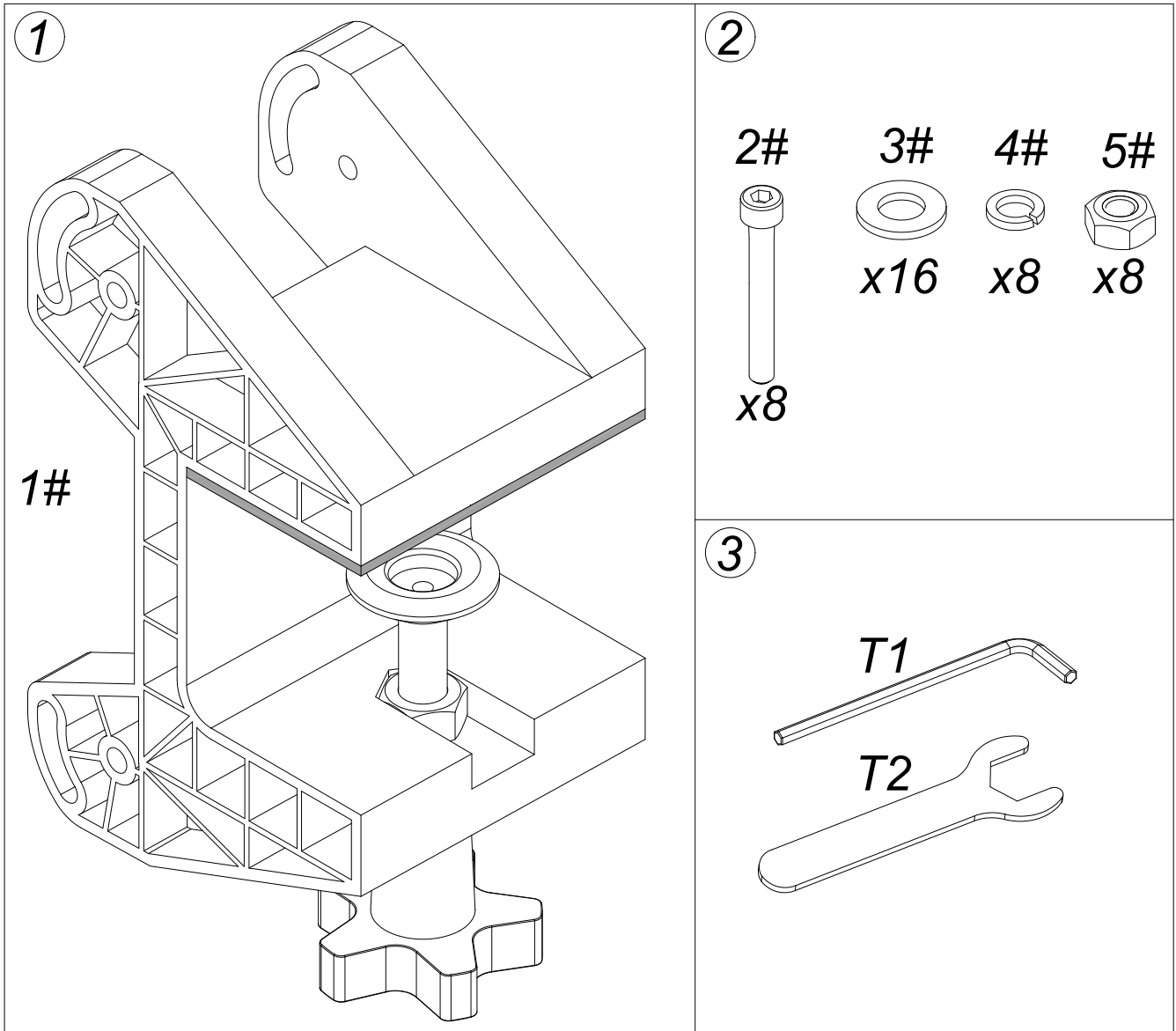

In this section, the materials shown in the figure will be described respectively as “MP1+NUMBER” (such as MP1 1#, MP1 2#, MP1 3#... ..)

Installation Method:

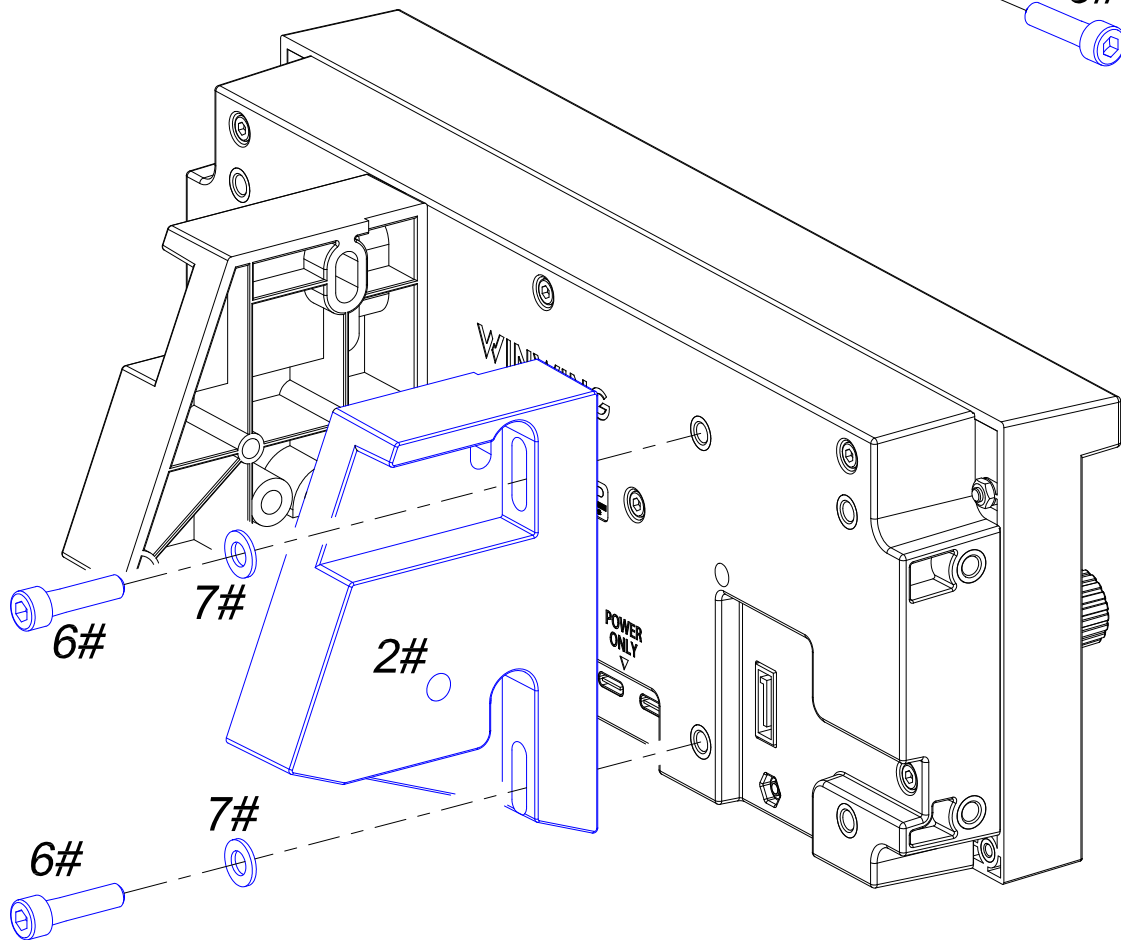
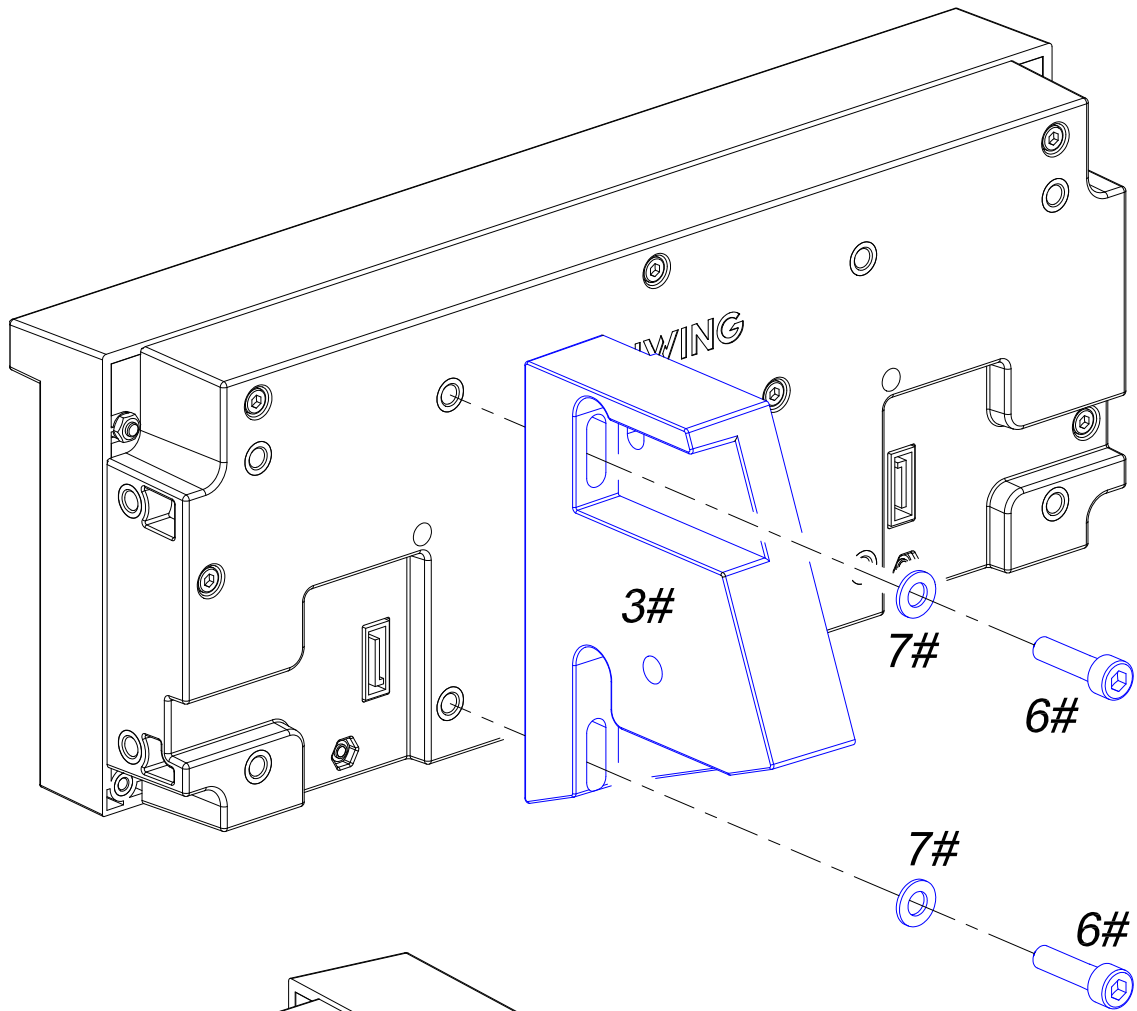

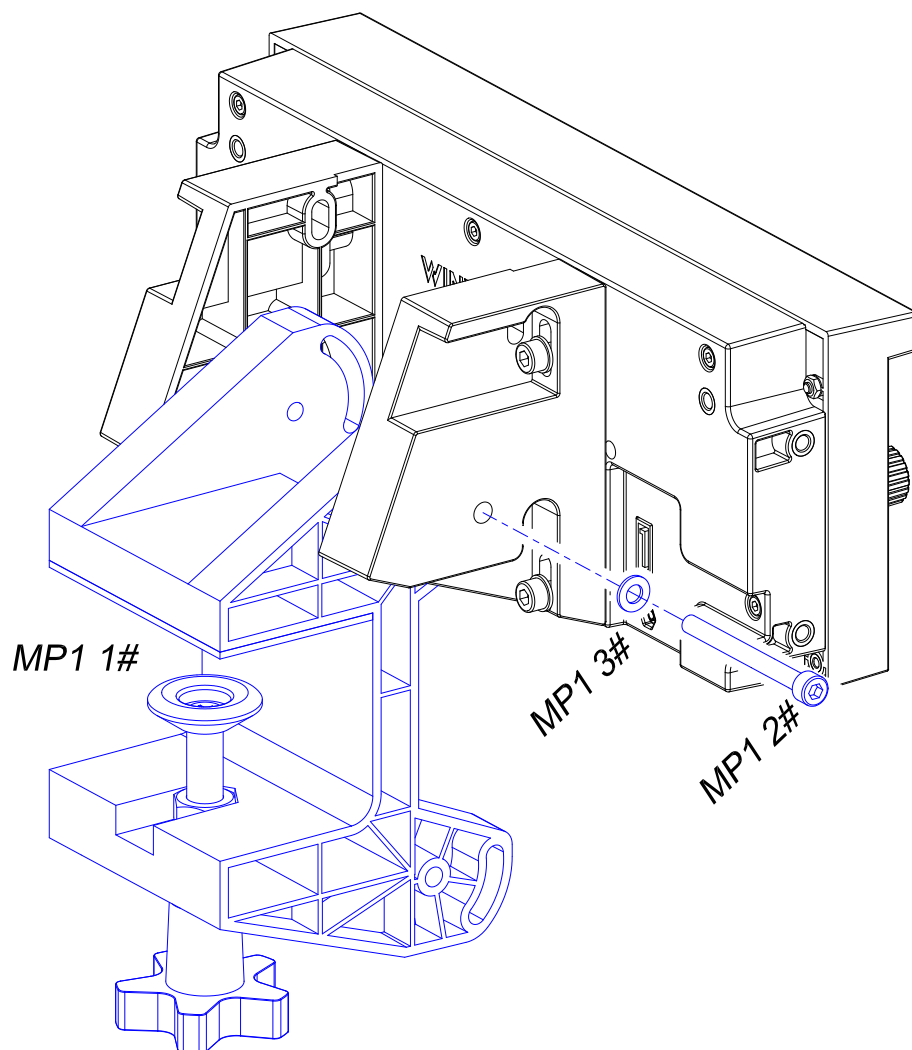
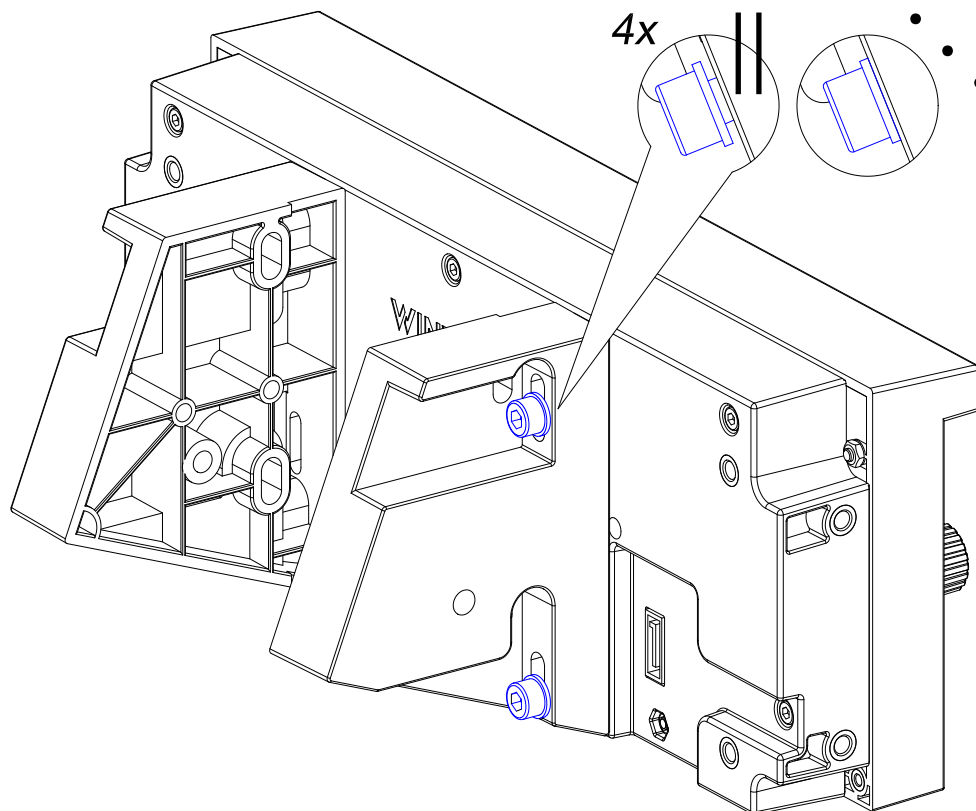

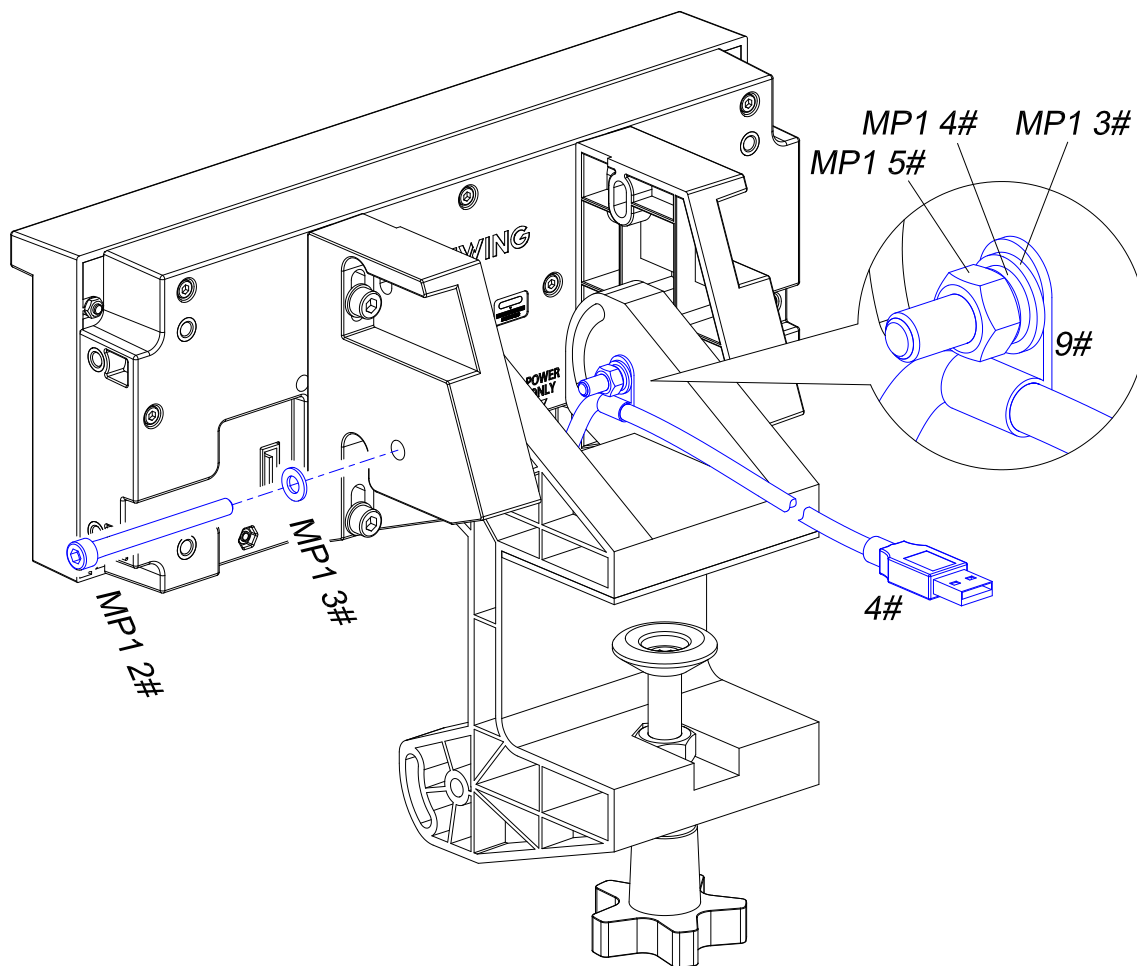

OR

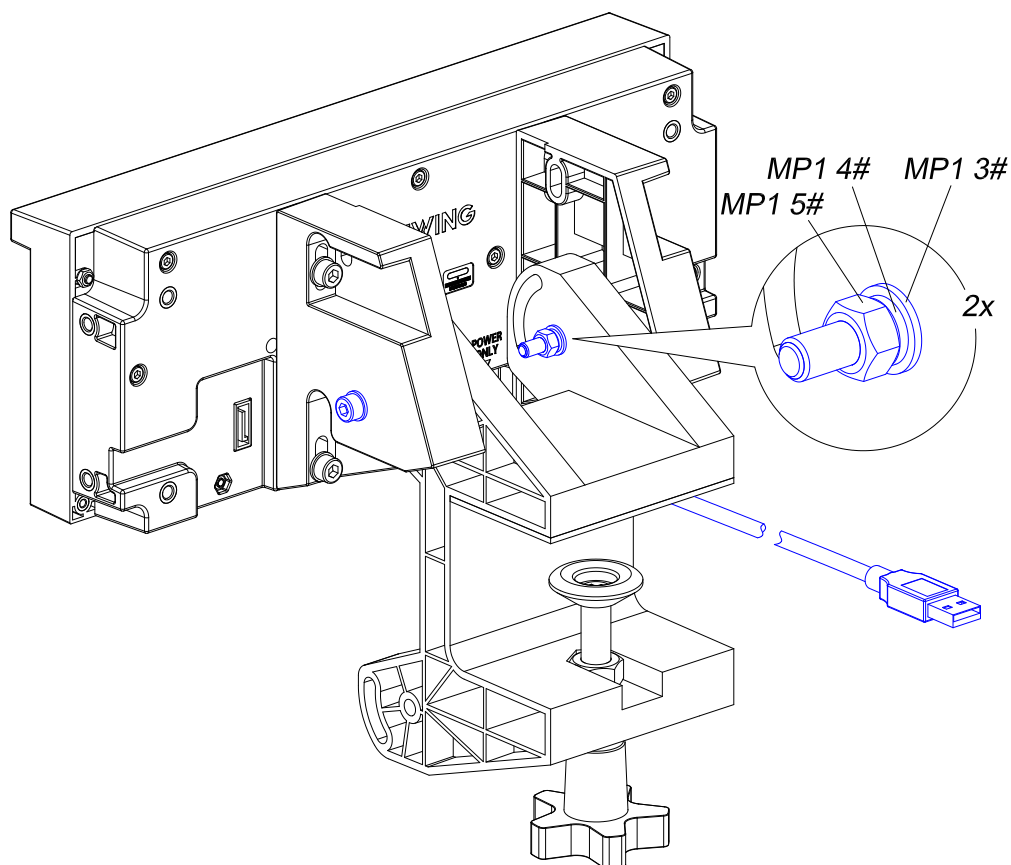

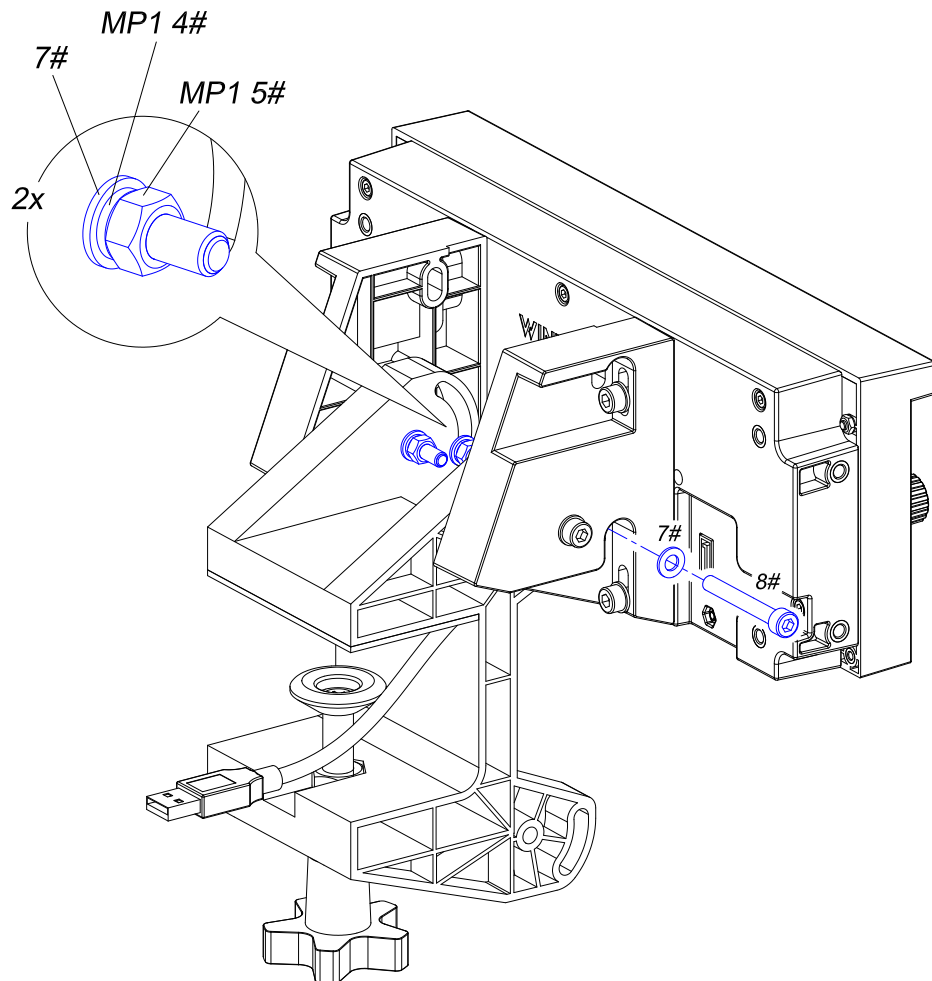
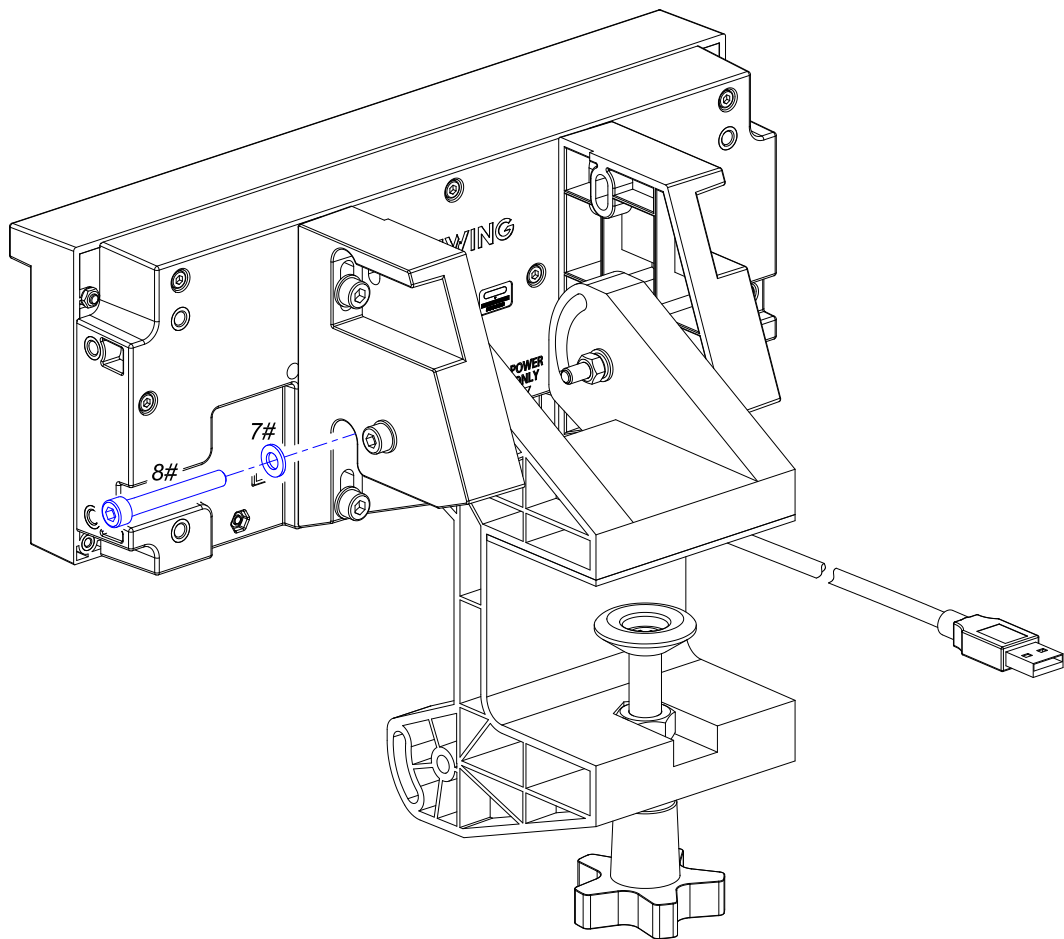

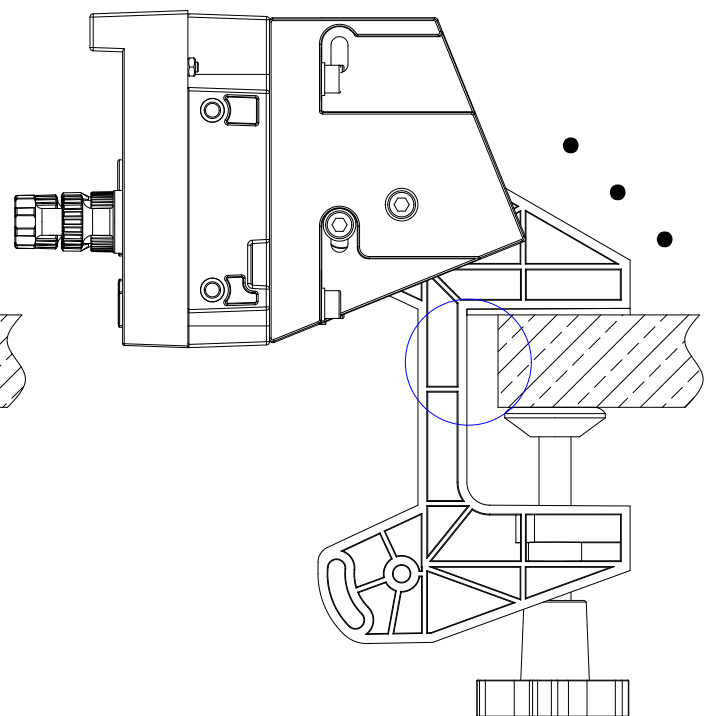
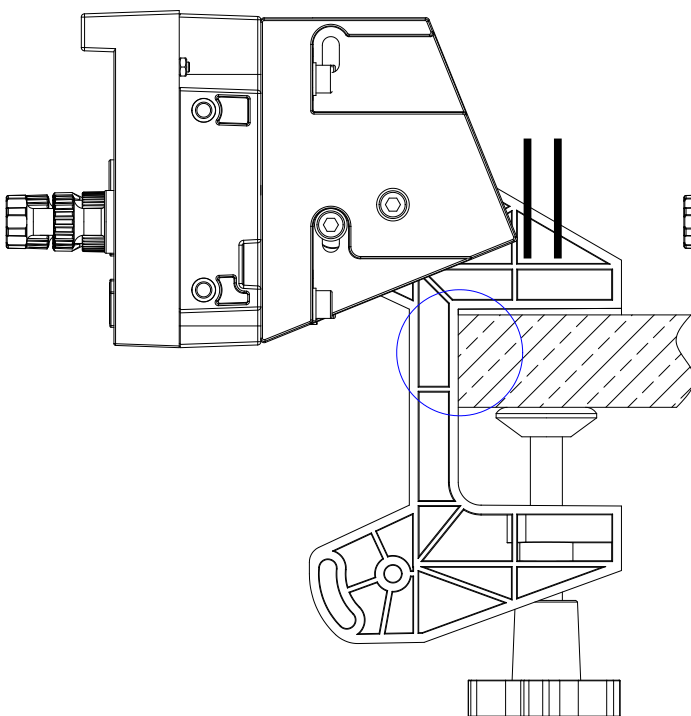
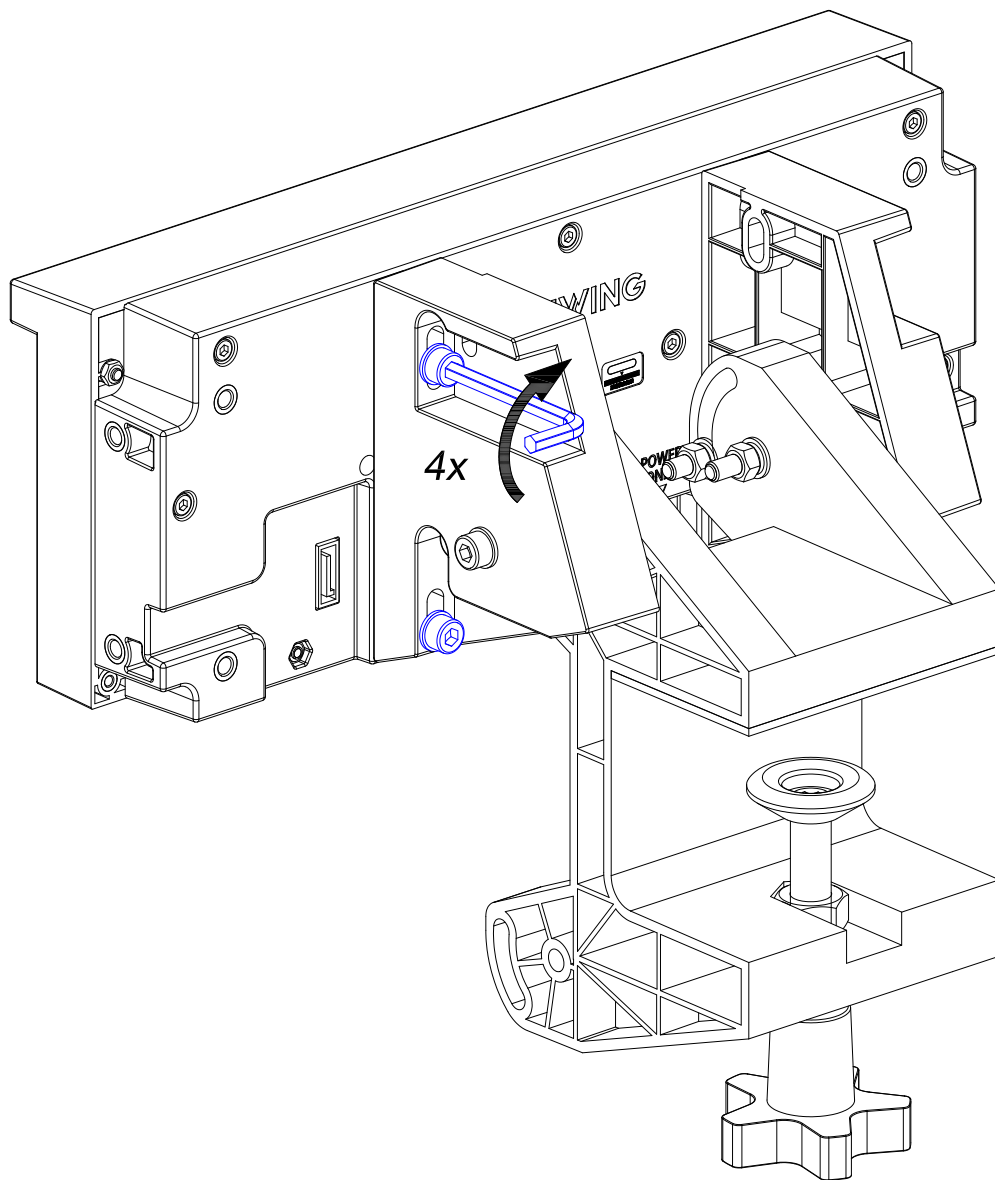

4.2 Gaming Seat Mounting

\

4.3 Cockpit Mounting*

Cockpit panel and installation screws need to be provided by the user.

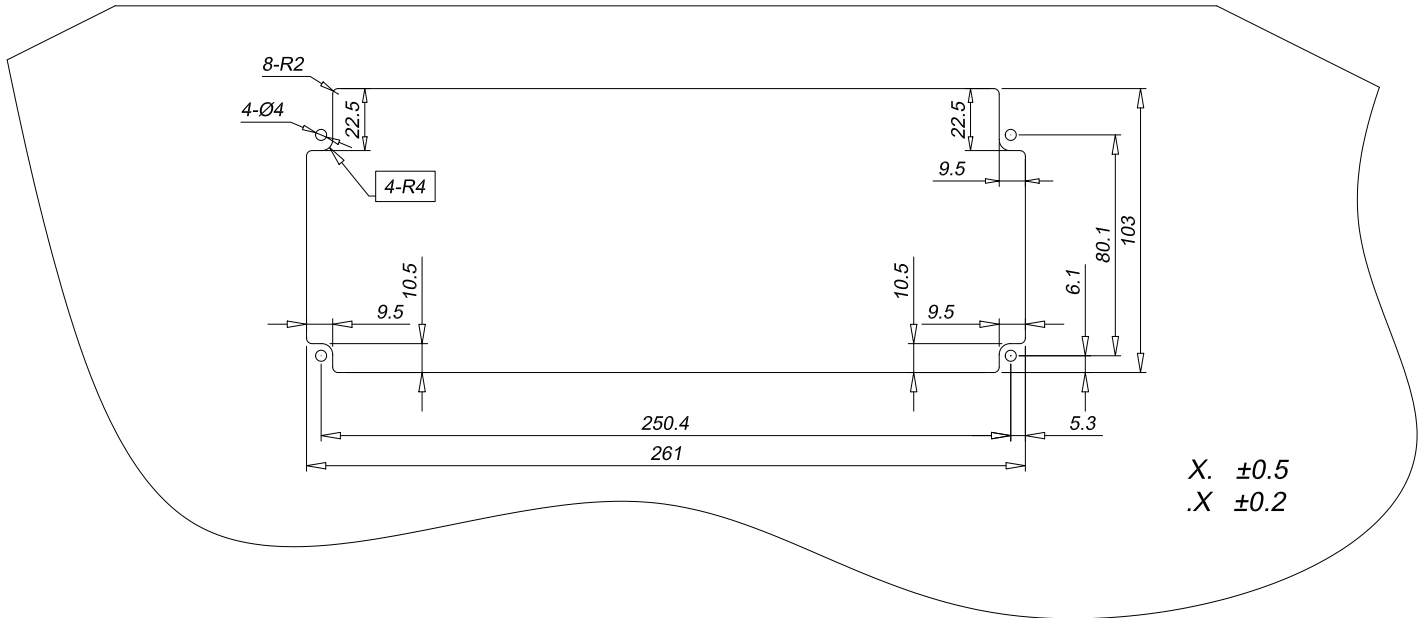

Cockpit panel mounting hole diagram

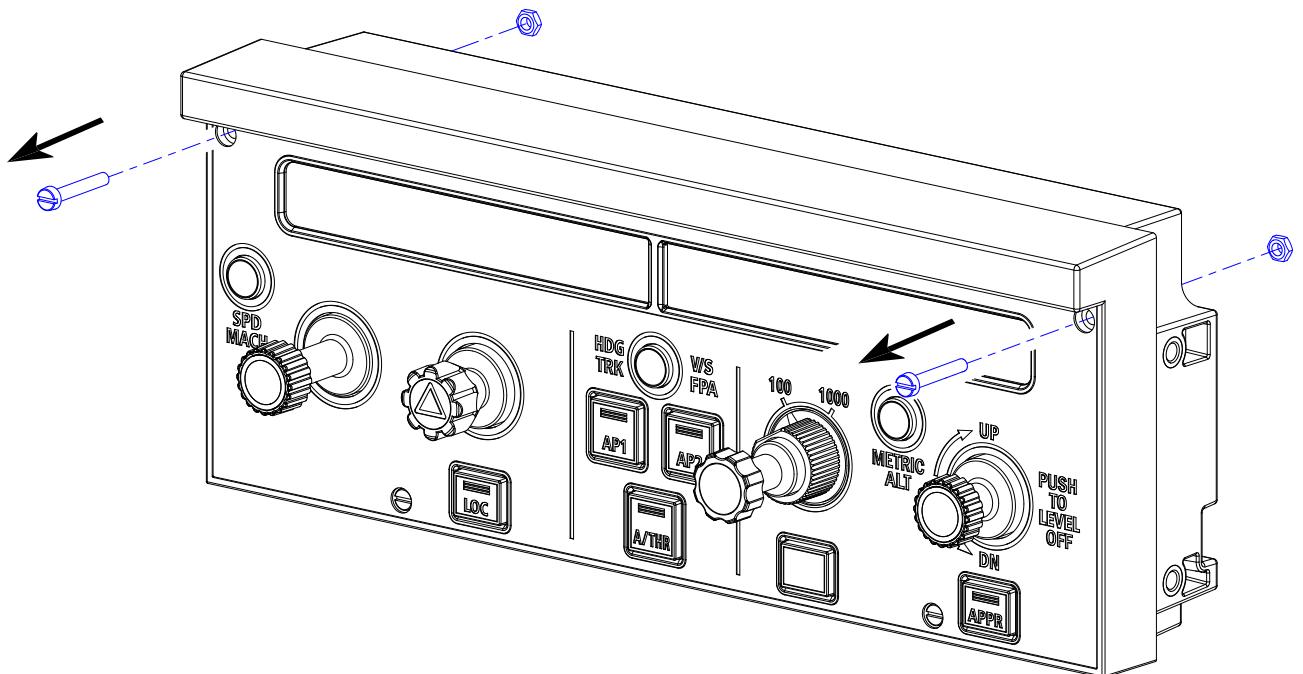

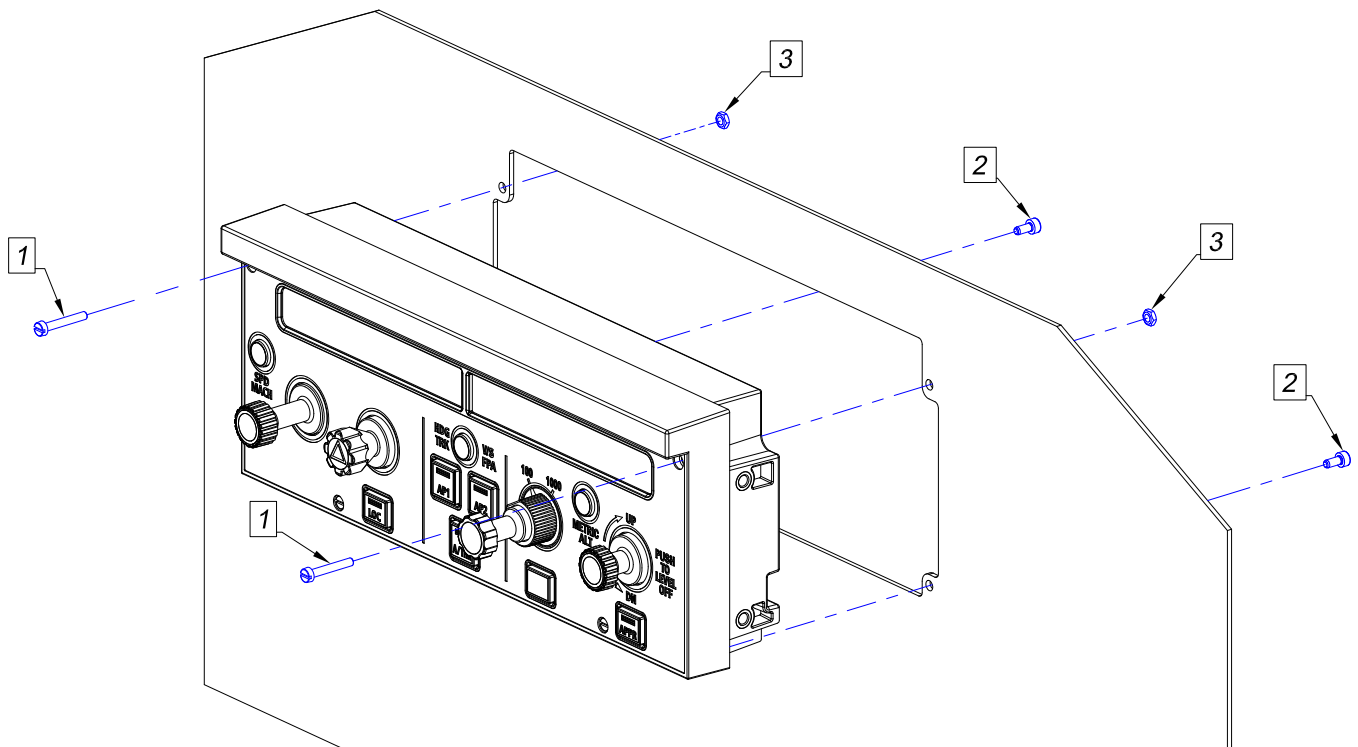

① Remove the screws and keep the nuts.

② Install FCU1 on the cockpit panel; screw specifications are as follows:

1	Screw specifications: M3, length = (22~25) + cockpit panel thickness.
2	Hexagon socket screw M3, length = (5~8) + cockpit panel thickness.
3	M3 Hexagon nut M3

4. 4Cascading

Can be cascaded with various control panels for installation, please stay tuned for the upcoming products for details.

*Contents are subject to updating without notice.

成都翼胜科技有限责任公司

WWW.WINWING.CN

INFO@WINWING.CN

High-tech International Enterprise Zone No.19 Building, Changshengqiao Road
1111#, Pidu District, Chengdu, China 610000