

DAMPER1

User Manual V1.0 2024.02

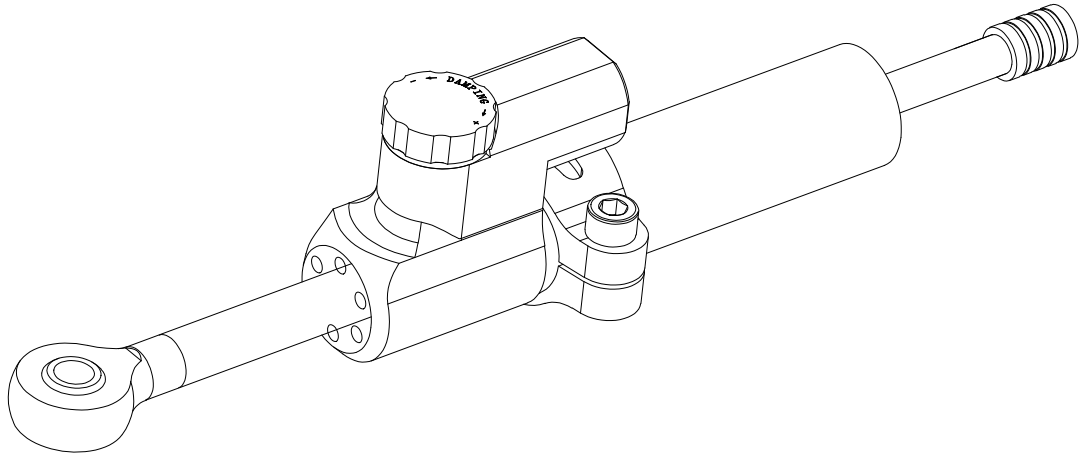

*Due to different production batches, please refer to the actual product.

1. Damper1 Installation instruction

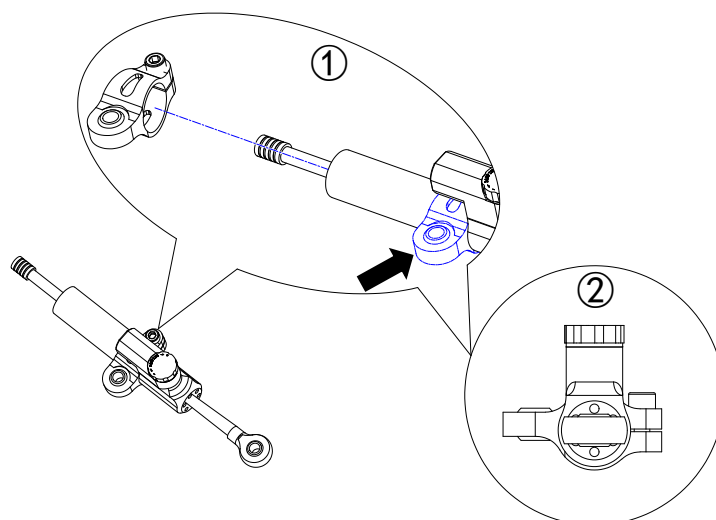

① Place the component into the bottom of the damper as shown in the diagram.
(*Screws of the component facing upwards).

② Verify that the component is in a vertical position with respect to the damper as shown in the diagram.

T4

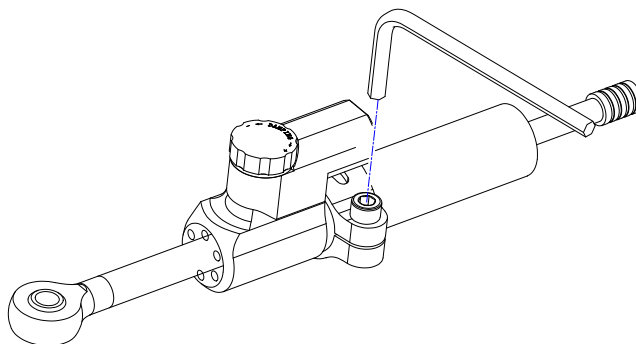

③ Tighten the screws with an internal hex wrench (T4) as shown in the diagram. (*The screws are included with the component; refer to the R1 manual for the internal hex wrench model)

*Content is subject to update without prior notice.

成都翼胜科技有限责任公司

WWW.WINWING.CN

INFO@WINWING.CN

High-tech International Enterprise Zone No.19 Building,
Changshengqiao Road 1111#, Pidu District, Chengdu, China 610000.